

PRODUCT PRESENTATION – 28CRT



- **102" Wide-Body Design**
- **Optional Wireless Back-Up Camera**
- **Flat Floor Wall-to-Wall – No Wheel Wells**
- **Optional 32" Living Room / Bedroom TVs**
- **16" Deluxe Aluminum Alloy Wheels**
- **Living Room Slideout w/Sofa**
- **Dual Swivel Rockers w/Table**
- **Optional On-Board Air Compressor/Tank**
- **Power Awning w/LED Light Strip**
- **Optional 7000-Lb. Axles w/Load Range G Tires**
- **Optional Rockford Fosgate® Exterior Audio System**



The Journey Begins...

28CRT — EXTERIOR



28CRT — FLOORPLAN & SPECS

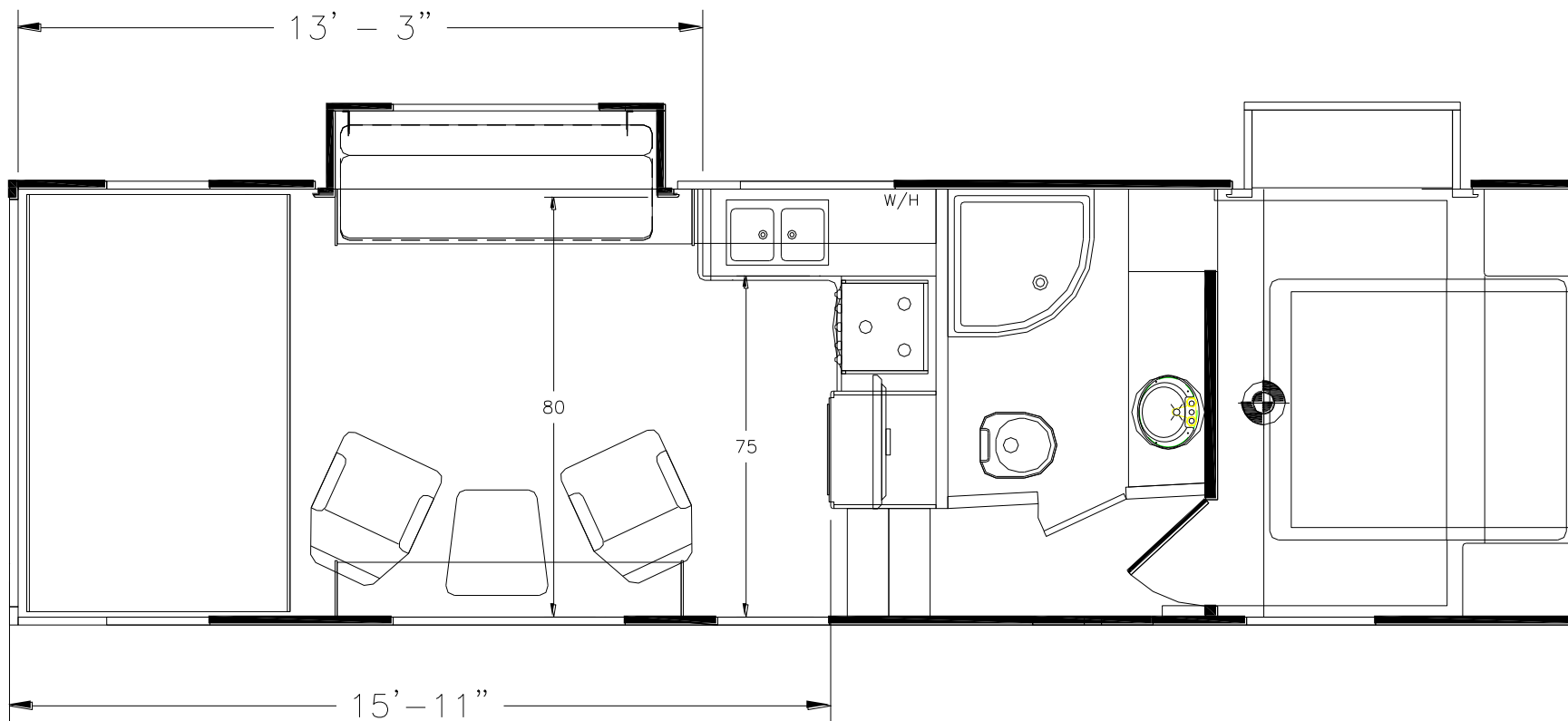

All product data, graphics, and photography in this document were as accurate as possible at time of publication. Subsequent refinements during the model year may be evident in the actual product. Genesis Supreme reserves the right to change colors, material, equipment and specifications without notice, and to add, modify or discontinue models shown in promotional materials. Standard/Optional Features and Specs may change without notice. Photographs of interiors & exteriors depicted on this website are strictly representational - colors, materials, appliances, fabrics, etc. may vary or change without notice. Unloaded vehicle weight and carrying capacity capacities will vary depending on optional equipment. Dry weight is measured from standard build and will vary with options. Weight of water, LP gas, fuel and options are not included in Cargo Capacity payload.

| UNIT SPECS | |
|---|---------|
| | 28CRT |
| OVERALL LENGTH | 32' 10" |
| GVWR (lbs) | 13,800 |
| DRY WEIGHT (lbs) | 10,600 |
| HITCH WEIGHT (lbs) | 2,650 |
| AXLE WEIGHT (lbs) | 7,950 |
| AXLE CAPACITY (lbs) | 7,000 |
| CARGO CAPACITY (lbs)** | 3,200 |
| TIRE SIZE | 16" |
| FRESH WATER (GAL) | 100 |
| GRAY WATER (GAL) | 40 |
| BLACK TANK (GAL) | 40 |
| Note: Weights may change due to options added. | |

Included in Base Price



- ***HIGH PROFILE 5th-Wheel***
- ***Slam-Door Luggage Compartments***
- ***4.5 KW Yamaha Generator w/Transfer Switch***
- ***A/C 13.0K BTU w/Ducting***
- ***102" Wide Body Design***
- ***Flipped Axles — No Wheel Wells (Flat Floor Wall-to-Wall)***
- ***16" Deluxe Aluminum Alloy Wheels***
- ***Two Swivel/Rocker Chairs w/Table, Roadside Sofa***
- ***Inset Coffered Ceiling Panel w/LED & Accent Lights***
- ***Countertop Edge Switched LED Lighting***
- ***Power Awning w/LED Light Strip***
- ***35,000 BTU Furnace***
- ***One-Piece PVC Vinyl Roof***
- ***12-Volt, 10 Cu. Ft. Refrigerator***
- ***Single 200W Solar Panel***
- ***Rear Spoiler***
- ***Metal Lavy Sink w/Stainless***
- ***Three-Burner, Glass Top Range w/Oven***
- ***Spray-Away®***
- ***TV Antenna w/Cable & Satellite Hook-Up***
- ***Two (2) Stab Jacks (Rear)***
- ***12-Volt Powered Fan Lavy Roof Vent***
- ***Bunk Area Roof Vent***
- ***Skylight Above Shower***
- ***Sani-Flush® Black Tank Flush***
- ***Plumbed for Exterior LP Hookup***
- ***LED Rope Lights/Living Room Valances***
- ***LED Interior Lighting Throughout***
- ***Dual 30-Lb. LP Tanks***

See order form for complete list of standard features & options.

See order form for complete list of standard features & options.



➤ **Arctic Package**

Includes: Heated, Enclosed Tanks/Valves
Reflected Floor Insulation
Furnace Heat Ducting System
Double Ceiling Insulation

➤ **Power & Cooling Upgrade Package**

Includes: 6.0KW Yamaha Generator Upgrade
13.5K BTU Bedroom A/C w/Wall Control, 50-Amp Service

➤ **Deluxe Package**

Power Sofa Bed (Rear) & Upper Bunk (Powered)
Shower & Glass Enclosure
Stainless, Deep Galley Sink w/Pull-Down Faucet
Microwave (Extra Large Over-the-Range Residential)
Exterior TV Bracket & Hookups
Queen Mattress w/Coordinated Bedspread
Three 12-Volt USB Chargers
Black Roller Shades Throughout
Solid Surface Galley Countertop w/Covers
Upgraded FM/AM Bluetooth® Audio Interior & Exterior

➤ **Supreme Package**

Dual landing gear motors with dual switch
7000-lb. Dual Axles w/16" Wheels/LR G Tires
40-Gallon Fuel Station
External 110-Volt Electrical Outlets
Spare Tire & Carrier

➤ **Premier Package**

8-Foot Laminated Ramp Door w/Beaver Tail
Aluminum-Framed & Laminated Hi-Gloss Fiberglass Sidewalls
Painted & Clear-Coated Designer Front Cap w/LEDs
10-Gallon Two-Way 110-Volt/LP DSI Water Heater
Sewer Hose Compartment
LED Exterior Flood Lights
LED Exterior Running Lights & Taillights

28CRT — POPULAR OPTIONS

See order form for complete list of standard features & options.



- **Power & Cooling Upgrade Pkg. w/6.0 Yamaha Generator**
- **Power & Cooling Upgrade Pkg. w/Onan 7000i DF Generator IPO Yamaha 6.0**
- **Onan 4.0 Gen CARB IPO STD 4.5 Yamaha (Forced for California)**
- **Hydraulic Jack**
- **Slide-Out Living Room**
- **Livingroom Slide-out Entertainment Center w/50" TV, Pantry and Fireplace IPO Sofa**
- **Bedroom Slideout w/Single Wardrobe & Vanity**
- **Patio Railing System**
- **Opposing Rear Power Dinette**
- **Rear Power Patio Awning**
- **Wireless Back-up Camera**
- **200W Solar w/1500W Pass Thru Inverter**
- **32" Living Room TV**
- **32" Bedroom TV**
- **Rear Screen Wall**
- **Rear Pull-Down Screen**
- **Stainless Steel Galley Package**
- **Central Vacuum System**
- **Carpet Kit**
- **Ceiling Fan (Soffit Delete)**
- **Upgraded Power Lavy Vent**
- **Upgraded Power Bedroom Vent**
- **Walk-on Roof w/Folding Ladder**
- **Equa-Flex® Suspension**
- **Keyless / Remote Entry Lock**
- **Galley Coffee Maker Stand**
- **15K BTU A/C IPO 13.5K BTU**
- **Frameless Single-Pane Windows**
- **Arctic Package**
- **Memory Foam Mattress**
- **Double Insulated Roof**
- **Cable Kit**
- **Additional 12-Volt USB Charger**
- **Water Filter**
- **Winterized**
- **Fold-Down Stairs w/Folding Entry Door Handle**
- **Exterior Rockford Fosgate® Audio System**
- **Patriotic Package (Must Choose a Graphic Base Color)**

28CRT — LIVING AREA

Well-Furnished, Functional, Stylish Interior



Two Swivel/Rockers w/Table



Opposing Rear Dinette

28CRT — LIVING AREA

Well-Furnished, Functional, Stylish Interior



*Audio Control Center/
Solar Controls*



*Black Roller Shades
Throughout*



*Central Monitor/Control
Panel*



Slideout Sofa



Optional 32" Living Area TV



*Practical Overhead &
Accent Lighting*



*Optional Power
Dinette Bed*

Efficient, Well-Appointed Kitchen w/Generous Storage



*Deep Stainless Sink
w/Single Handle Faucet
Solid Surface Countertops*



Spacious, Open Floorplan



*Efficient Meal Prep Center
3-Burner, Glass Top Range w/Oven*



12-Volt, 10 Cu. Ft. Refrigerator

28CRT — BEDROOM (Shown with optional bedroom slideout)

Bedroom Slideout w/Walk-Around Bed & Wardrobe/Vanity



Deep Drawer/Wardrobe Storage



Shiplap Accent Wall w/In-Wall Storage



Slideout Vanity/Wardrobe



Under-Bed Storage



Fiberglass Shower w/Glass Door, Overhead Skylight & Designer Fixtures



Generous Shower/Lavy Storage



Stainless Sink/Designer Fixture



Mirrored Medicine Cabinet

28CRT — EXTERIOR FEATURES & OPTIONS



Pass-Thru Front Storage



Yamaha 4.5KW Generator



1500W Inverter



Optional On-Board Air Compressor



Exterior Shower



Spray-Away®



"Arctic" Package



On-Board Air Quick Connect



Optional Equi-Flex® Suspension



16" Deluxe Aluminum Alloy Wheels



Optional 40-Gallon Fuel Station



Exterior Ladder & Walk-On Roof

28CRT

Thank you – please contact us & visit our website!



**Genesis Supreme RV
23129 Cajalco Road
Perris, CA 92570
(951) 337-0254**

genesissupremerv.com

The Journey Begins...