

# PRODUCT PRESENTATION – 3016BIKS



- **SUNSATION® Exterior Wall Laminate for Extreme UV Resistance and Color Stability**
- **102" Wide-Body Design**
- **Wireless Back Up Camera Option**
- **Flat Floor Wall-to-Wall / No Wheel Wells**
- **16" Deluxe Aluminum Alloy Wheels**
- **50" TV Entertainment Center**
- **32" Bedroom TV**
- **Large Living Room Slideout w/Sofa & Refer/Pantry**
- **Dual Swivel Rockers**
- **Optional On-Board Air Compressor/Tank**
- **Power Awning w/LED Light Strip**



*The Journey Begins...*

# 3016BIKS -- Exterior

102" Wide-Body, 16" Aluminum Alloy Wheels



# 3016BIKS — Floorplan & Specs

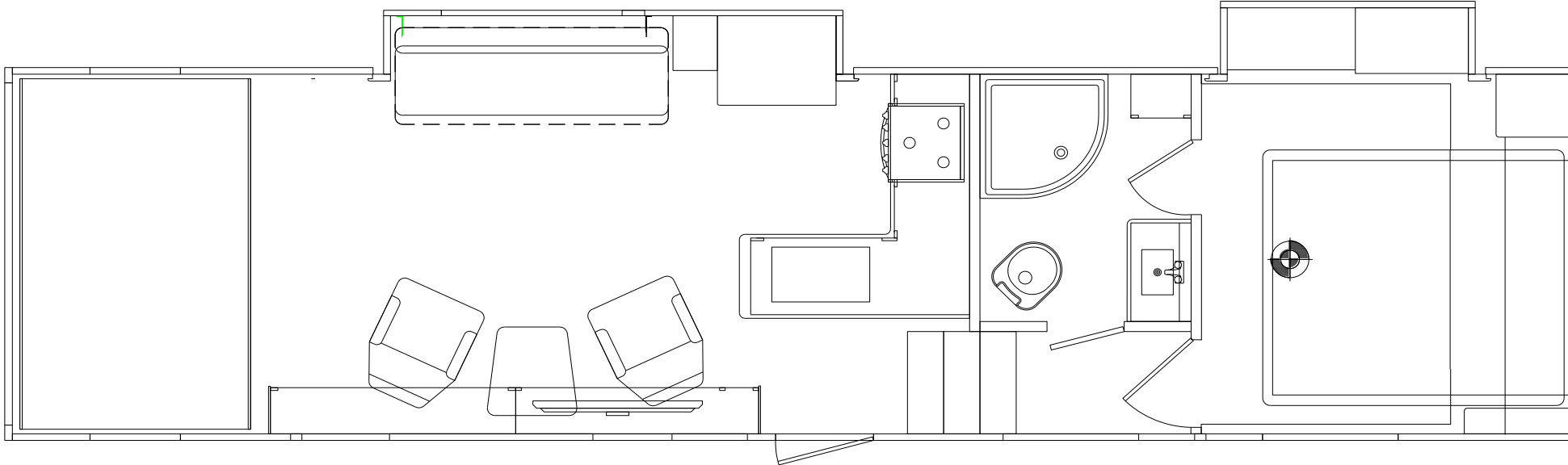

All product data, graphics, and photography in this document were as accurate as possible at time of publication. Subsequent refinements during the model year may be evident in the actual product. Genesis Supreme reserves the right to change colors, material, equipment and specifications without notice, and to add, modify or discontinue models shown in promotional materials. Standard/Optional Features and Specs may change without notice. Photographs of interiors & exteriors depicted on this website are strictly representational - colors, materials, appliances, fabrics, etc. may vary or change without notice. Unloaded vehicle weight and carrying capacity capacities will vary depending on optional equipment. Dry weight is measured from standard build and will vary with options. Weight of water, LP gas, fuel and options are not included in Cargo Capacity payload.

UNIT SPECS	
	3016BIKS
OVERALL LENGTH	36 "10"
GVWR (lbs)	15,000
DRY WEIGHT (lbs)	11,560
HITCH WEIGHT (lbs)	2,700
AXLE WEIGHT (lbs)	8,860
AXLE CAPACITY (lbs)	7,000
CARGO CAPACITY (lbs)**	3,440
TIRE SIZE	16"
FRESH WATER (GAL)	160
GRAY WATER (GAL)	50
BLACK TANK (GAL)	50
Note: Weights may change due to options added.	

## Standard Features - Included in Base Price

- **4.0 KW ONAN Generator w/Transfer Switch**
- **Bedroom Slideout Duo Vanity/Wardrobe**
- **15.0K BTU A/C w/Ducting**
- **102" Wide-Body Design**
- **Flipped Axles - No Wheelwells (Flat Floor Wall-to-Wall)**
- **16" Deluxe Aluminum Alloy Wheels**
- **Two Swivel/Rockers w/Table, Slide-out Sofa Bed**
- **Rear Table and Legs**
- **50" Living Room TV w/Swivel Bracket**
- **32" Bedroom TV w/ Swivel Bracket**
- **Inset, Coffered Ceiling Panel w/LED & Accent Lights**
- **Countertop Edge LED Lighting - Switched**
- **Power Awning w/LED Light Strip**
- **35,000 BTU Furnace**
- **One-Piece PVC Vinyl Roof**
- **Slam-Door Luggage Compartments**
- **Stereo AM/FM/CD/DVD w/Bluetooth/USB/Subwoofer**
- **Dual 30-Lb. LP Tanks**
- **12V 10 Cu. Ft. Refrigerator**
- **Rear Spoiler**
- **Rear Screen Wall**
- **3-Burner Range w/Oven**
- **Spray-Away® Hose Sprayer**
- **TV Antenna w/Cable & Satellite Hook-Up**
- **Two Rear Stab Jacks**
- **Upgraded Galley Roof Vent**
- **12V Powered Fan Lavy Roof Vent**
- **Bunk Area Roof Vent**
- **Skylight Above Shower**
- **Sani-Flush® Black Tank Flush**
- **Carpet Kit**
- **Bunk Ladder**
- **Plumbed for Exterior LP Hookup**
- **LED Rope Lights/Living Room Valances**
- **LED Interior Lighting Throughout**
- **Metal Lavy Sink w/Stylish Faucet**
- **Water Filter**
- **Large Living Room Slideout w/Sofa & Refer/Pantry Cabinet**

See order form for complete list of standard features & options.

- **Power & Cooling Upgrade Pkg\***
- **Hydraulic Jack**
- **Patio Railing System**
- **Opposing Rear Power Dinette**
- **Rear Power Patio Awning**
- **Wireless Back Up Camera**
- **Dual 8,000 Lb. Axles**
- **Single 200W Solar Panel w/1500W Pass Thru Inverter**
- **Stainless Steel Galley Package**
- **Ceiling Fan (Soffit Delete)**
- **Central Vacuum System**
- **Keyless/Remote Entry Lock**
- **Queen Bed Memory Foam**
- **EZ-Flex® Suspension**
- **Arctic Package\*\***
- **Upgraded Lavy Fan w/Remote**
- **Upgraded Rear or Bedroom Fan w/Remote**
- **2nd Grey Tank**
- **Additional USB 12V Charger**
- **Double Insulated Roof**
- **Cable Kit**
- **Tool Box**
- **Rear Pull Down Screen**
- **Winterized**
- **Fold Down Stairs w/Fold Entry Door Handle**

## **Supreme Package**

Dual Landing-Gear Motors w/Dual Switch  
7000 Lb. Dual Axles w/16" wheels/LR G Tires  
40-Gallon Fuel Station  
External 110V Electrical Outlets  
Spare Tire & Carrier

## **\*Power & Cooling Upgrade Package**

*Includes:* 5.5KW Onan Generator Upgrade  
13.5K BTU Bedroom AC w/Wall Control, 50-Amp Service

## **\*\*Arctic Package**

*Includes:* Heated, Enclosed Tanks/Valves  
Reflected Floor Insulation  
Furnace Heat Ducting System  
Double Ceiling Insulation

## **Premier Package**

8-Foot Laminated Ramp Door w/Beaver Tail  
Aluminum-Framed, Laminated, Hi-Gloss Fiberglass Sidewalls  
Large Designer Front Cap w/LED's  
Exterior Folding Ladder w/ Walk-on Roof  
10-Gallon Two-Way 110V/LP DSI Water Heater  
Sewer Hose Compartment  
LED Exterior Flood Lights  
LED Exterior Running Lights & Taillights

## **Deluxe Package**

Power Rear Sofa Bed & Power Upper Bunk  
Shower w/Glass Enclosure  
Stainless Deep Galley Sink w/Pull-Down Faucet  
Microwave (Extra Large Over-the-Range Residential)  
Exterior TV Bracket & Hookups  
RV King Memory Foam Mattress & Coordinated Bedspread  
Three 12V USB Chargers  
Black Roller Shades Throughout  
Solid Surface Galley Countertop w/Covers

***See order form for complete list of standard features & options.***

## Well-Equipped, Functional, Stylish Interior



*Two Swivel/Rockers w/Table  
(Optional Euro Recliners Shown)*



*Slideout Sofa*



*Generous Slideout Overhead  
Storage*



*Opposing Rear Dinette w/Table*



*50" Living Room TV  
w/Overhead Storage*



## Efficient, Well-Appointed Kitchen w/Generous Storage



*Solid Surface Countertops*



*Deep Stainless Sink w/Pull-Down Faucet*



*3-Burner Glass Top Range  
w/Oven*

## Bedroom w/Walkaround King Bed / Slideout Vanity / Wardrobe



*Walk-Around King Bed*



*Slideout Vanity/Wardrobe*



*Private Lavy Access*



*Overhead & Deep Drawer/Wardrobe Storage*



*Fiberglass Shower w/Glass Door & Overhead Skylight*



*Stainless Sink/Designer Fixtures/Mirrored Medicine Cabinet*



*Generous Shower/Lavy Storage*

# 3016BIKS Exterior Features & Options



*Pass-Thru Front Storage*



*Optional Onan 5.5KW Generator*



*40-Gallon Fuel Station*



*1500W Inverter*



*Spray-Away®*



*Exterior TV Hookups  
& Bracket*



*On-Board Air  
Quick Connect*



*Optional On-Board Air Compressor*



*Optional Tool Box*



*"Arctic" Package*



*Optional Equa-  
Flex® Suspension*



*16" Deluxe Aluminum  
Alloy Wheels*



*Exterior Folding Ladder  
& Walk-On Roof*



*Black Roller Shades  
Throughout*



*Coffered Ceiling Panel  
w/LED & Accent Lights*



*Optional Power Dinette Bed*



*Slideout Sofa Bed*



*Central Monitor/Control  
Panel*



*Media Control Center*



*Slideout  
Magazine Rack*



*Generous Overhead Storage*

**3016BIKS**

***Thank you – please contact us & visit our website!***



**Genesis Supreme RV  
23129 Cajalco Road  
Perris, CA 92570  
(951) 337-0254  
[genesissupremerv.com](http://genesissupremerv.com)**



*The Journey Begins...*