

PRODUCT PRESENTATION – 28CRT



- **SUNSATION® Exterior Wall Laminate for Extreme UV Resistance and Color Stability**
- **102" Wide-Body Design**
- **Wireless Back Up Camera Option**
- **Flat Floor Wall-to-Wall / No Wheel Wells**
- **Optional 32" Living Room / Bedroom TVs**
- **16" Deluxe Aluminum Alloy Wheels**
- **Living Room Slideout w/Sofa**
- **Dual Swivel Rockers w/Table**
- **Optional On-Board Air Compressor/Tank**
- **Power Awning w/LED Light Strip**



**GENESIS
SUPREME**

The Journey Begins...

28CRT — EXTERIOR

102" Wide-Body, 16" Aluminum Alloy Wheels



28CRT — FLOORPLAN & SPECS

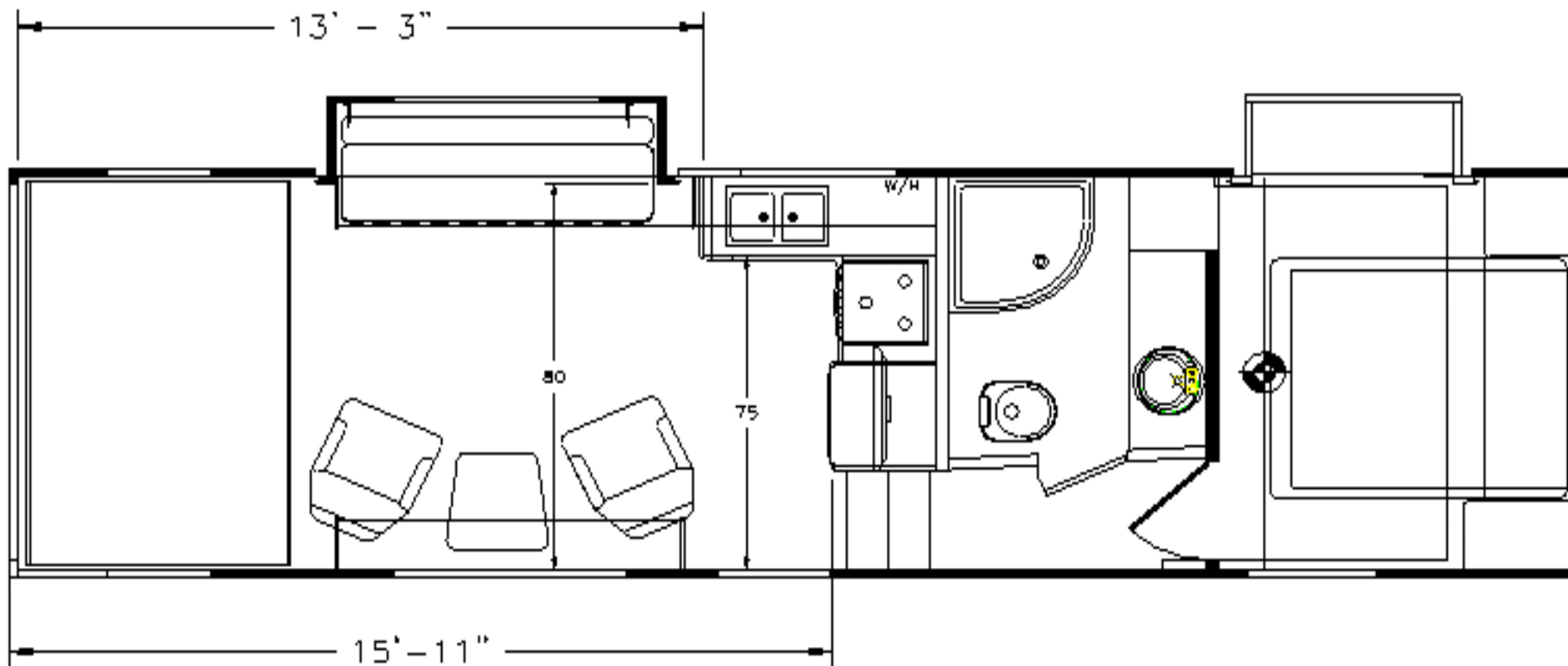

All product data, graphics, and photography in this document were as accurate as possible at time of publication. Subsequent refinements during the model year may be evident in the actual product. Genesis Supreme reserves the right to change colors, material, equipment and specifications without notice, and to add, modify or discontinue models shown in promotional materials. Standard/Optional Features and Specs may change without notice. Photographs of interiors & exteriors depicted on this website are strictly representational - colors, materials, appliances, fabrics, etc. may vary or change without notice. Unloaded vehicle weight and carrying capacity capacities will vary depending on optional equipment. Dry weight is measured from standard build and will vary with options. Weight of water, LP gas, fuel and options are not included in Cargo Capacity payload.

UNIT SPECS	
	28CRT
OVERALL LENGTH	32' 10"
GVWR (lbs)	13,800
DRY WEIGHT (lbs)	10,600
HITCH WEIGHT (lbs)	2,650
AXLE WEIGHT (lbs)	7,950
AXLE CAPACITY (lbs)	7,000
CARGO CAPACITY (lbs)**	3,200
TIRE SIZE	16"
FRESH WATER (GAL)	100
GRAY WATER (GAL)	40
BLACK TANK (GAL)	40
Note: Weights may change due to options added.	

Standard Features - Included in Base Price

- **HIGH PROFILE 5th wheel**
- **Slam-Door Luggage Compartments**
- **4.5 KW YAMAHA Generator w/Transfer Switch**
- **A/C 13.0K BTU w/Ducting**
- **102" Wide Body Design**
- **Flipped Axles w/No Wheelwells (Flat Floor Wall-to-Wall)**
- **16" Deluxe Aluminum Alloy Wheels**
- **Two Swivel/Rocker Chairs w/Table, Sofa RS**
- **Inset Coffered Ceiling Panel w/LED & Accent Lights**
- **Countertop Edge LED Lighting - Switched**
- **Power Awning w/LED Light Strip**
- **35,000 BTU Furnace**
- **One-Piece PVC Vinyl Roof**
- **12V 10 Cu. Ft. Refrigerator**
- **Single 200W Solar Panel**
- **Rear Spoiler**
- **Metal Lavy Sink w/Stainless**
- **Three-Burner, Glass Top Range w/Oven**
- **Spray-Away®**
- **TV Antenna w/Cable & Satellite Hook-Up**
- **Two (2) Stab Jacks (Rear)**
- **12V Powered Fan Lavy Roof Vent**
- **Bunk Area Roof Vent**
- **Skylight Above Shower**
- **Black Tank Flush**
- **Plumbed for Exterior LP Hookup**
- **LED Rope Lights/Living Room Valances**
- **LED Interior Lighting Throughout**
- **Stereo AM/FM/CD/DVD w/Bluetooth/USB**
- **Dual 30-Lb. LP Tanks**

See order form for complete list of standard features & options.

See order form for complete list of standard features & options.



- **Power & Cooling Upgrade Pkg**
- **Onan 5.5 Fuel Injection Generator IPO 6.0 Yamaha Gen**
- **Hydraulic Jack**
- **Upgraded Hitch Roto Flex (Forced Option)**
- **Slide-Out Living Room**
- **Bedroom Single Wardrobe w/Vanity Slideout**
- **Patio Railing System**
- **Euro Chairs (Forced Option)**
- **Opposing Rear Power Dinette**
- **Rear Power Patio Awning**
- **Wireless Back up Camera**
- **200W Solar w/1500W Pass Thru Inverter**
- **32" Living Room TV**
- **32" Bedroom TV**
- **Rear Screen Wall**
- **Rear PULL DOWN Screen**
- **Stainless Steel Galley Package**
- **Supreme Package (Forced Option)**
- **Premier Package (Forced Option)**
- **Deluxe Package (Forced Option)**
- **Central Vacuum System**
- **Carpet Kit**
- **Ceiling Fan (Soffit Delete)**
- **Upgraded Power Vent Lavy**
- **Upgraded Power Vent Bedroom**
- **Walk-on Roof w/ Folding Ladder**
- **Equa-Flex® Suspension**
- **Keyless / Remote Entry Lock**
- **Coffee Maker Stand in Galley**
- **15K BTU A/C IPO 13.5K BTU**
- **Frameless Dual-Pane Windows**
- **Arctic Packag**
- **Memory Foam Mattress**
- **Double Insulated Roof**
- **Cable Kit**
- **USB 12V Charger Addt'l**
- **Water Filter**
- **Winterized**
- **12V Air Compressor (Forced Option)**
- **Fold Down Stairs w/Fold Entry DR Handle**

See order form for complete list of standard features & options.



Arctic Package

Includes: Heated, Enclosed Tanks/Valves
Reflected Floor Insulation
Furnace Heat Ducting System
Double Ceiling Insulation

Power & Cooling Upgrade Package

Includes: 5.5KW Onan Generator Upgrade
13.5K BTU Bedroom A/C, 50-Amp Service

Deluxe Package

Power Sofa Bed (Rear) & Upper Bunk (Powered)
Shower & Glass Enclosure
Stainless, Deep Galley Sink w/Pull-Down Faucet
Microwave (Extra Large Over-the-Range Residential)
Exterior TV Bracket & Hookups
Queen Mattress w/ Coordinated Bedspread
Three 12V USB Chargers
Black Roller Shades Throughout
Solid Surface Galley Countertop w/Covers

Supreme Package

Dual landing gear motors with dual switch
7000-lb. Dual Axles with 16" wheels/LR G Tires
40-Gallon Fuel Station
External 110V Electrical Outlets
Spare Tire & Carrier

Premier Package

8-Foot Laminated Ramp Door w/Beaver Tail
Aluminum-Framed & Laminated Hi-Gloss Fiberglass Sidewalls
Large Designer Front Cap w/LED's
10-Gallon Two-Way 110V / LP DSI Water Heater
Sewer Hose Compartment
LED Exterior Flood Lights
LED Exterior Running Lights & Taillights

28CRT — LIVING AREA

Well-Furnished, Functional, Stylish Interior



Practical Overhead & Accent Lighting



*Slideout Sofa/Magazine Rack
Slideout Overhead Storage*



*Opposing Rear Dinette/Power Upper Bunk
(Shown converted into bed)*



Two Swivel/Rockers w/Table

Efficient, Well-Appointed Kitchen w/Generous Storage



3-Burner Glass Top Range w/Oven



Spacious, Open Floorplan



*Solid Surface Countertops/Sink Covers
Deep Stainless Sink w/Single Handle Faucet*



Efficient Meal Prep Center

28CRT — BEDROOM (Shown with optional bedroom slideout)

Bedroom Slideout w/Walkaround King Bed & Duo Vanity/Wardrobe



Walk-Around King Bed



Deep Drawer/Wardrobe Storage



Slideout Vanity/Wardrobe



Fiberglass Shower w/Glass Door, Overhead Skylight & Designer Fixtures



*Stainless Sink/Designer
Fixtures/Mirrored Medicine Cabinet
Generous Shower/Lavy Storage*

28CRT — EXTERIOR FEATURES & OPTIONS



Pass-Thru Front Storage



Optional Onan 5.5KW Generator



1500W Inverter



Optional On-Board Air Compressor



Spray-Away®



"Arctic" Package



On-Board Air Quick Connect



Exterior TV Hookups & Bracket



Optional Equa-Flex® Suspension



16" Deluxe Aluminum Alloy Wheels



Optional 40-Gallon Fuel Station



Exterior Folding Ladder & Walk-On Roof



*Black Roller Shades
Throughout*



Optional Power Dinette Bed



Slideout Sofa Bed



*Central Monitor/Control
Panel*



Media Control Center



*Slideout
Magazine Rack*

28CRT

Thank you – please contact us & visit our website!



Genesis Supreme RV
23129 Cajalco Road
Perris, CA 92570
(951) 337-0254
genesissupremerv.com



The Journey Begins...