

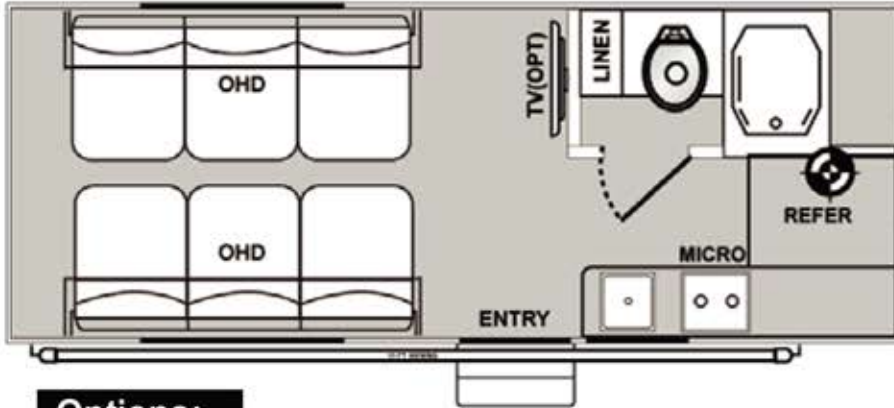

R155LTE SPEC SHEET



UNIT SPECS

OVERALL LENGTH	20'-1"
CARGO LENGTH	11'
GVWR (lbs)	6,500
DRY WEIGHT (lbs)	3933
HITCH WEIGHT (lbs)	768
AXLE WEIGHT (lbs)	3165
AXLE CAPACITY (lbs)	3500
CARGO CAPACITY (lbs)	2567
TIRE SIZE	14"
FRESH WATER (GAL)	50
GRAY WATER (GAL)	26
BLACK TANK (GAL)	26

Note: Weights may change due to options added.

Options:

- Aluminum Wheels IPO Black Steel
- Front Power Jack (Forced Option)
- 200W Solar Panel (Forced Option)
- Double Insulated Roof
- Exterior Premier Package(Forced Option)
- Interior Deluxe Package(Forced Option)
- Arctic Package*
- 15.0K BTU A/C Living Room (IPO 13.5K)
- TV - Living room (24")
- Drive On Wheel Well
- Winterized
- Cool Grey Exterior Sidewalls IPO White
- Sidewalls Sunstiation Glass(Forced Option)
- Patriotic Package
- Pacific West Associates Tag Req'd
- RVIA Tag Req'd
- Retractable Shower Door(Forced Option)

Interior Package

- Black microwave .9
- RTF Countertop
- Large Double Door Refrigerator (8 Cubic Foot)
- 18K Furnance
- Key Hooks
- Nite Shades

Exterior Package

- Power Awning w/LED Strip
- Sewer Hose Storage Compartment
- Four (4) Stab Jacks rear/ front
- Spare Tire & Carrier
- 14" Black Steel Rims D Rated Tires
- 6-Gallon Gas Water Heater

Standard Features - Included in Base Price

- 6" inch High Beam(Chassis)
- 84" Wide- Design
- 3500 dual axels
- White Fiberglass Laminated Aluminum-Framed Sidewalls
- 13.5K BTU Air Conditioner
- 75" Ramp Door White
- Dual 20-LB Propane Tanks w/Deluxe Cover
- 2 - Burner Cooktop
- Storage Shelf
- Tub/Shower Surround
- Extra-Large Windows(Radius & Tinted) & Valances
- Black Tank Flush
- Stainless Steel Galley Sink w/pull out faucet
- Equipped w/ BT and Upgraded Speakers
- LED Interior Lighting
- Seamless One-Piece Rubber Roof
- Fold Up Sofa's (2)
- 12v Powered Fan Roof Vents (Lavy)
- TV Antenna
- External 110v Electrical Outlet
- Metal Skirting
- Double Radius Entry Door Step
- Exterior Lights - Porch (1), Rear (2), Front (1)
- Tie-Downs Throughout
- Ceiling Roof Vent
- Rear Spoiler
- Front Wrap w/ Diamond Plate
- Large Table between Sofa's
- Spray Away
- Dump Station Light

Arctic Package* Includes Heated Enclosed Tanks, Reflected Floor Insulation, Heat Ducting System For Furnace, Double Insulation in Ceiling

Note: Due to possible changes from suppliers, Genesis Supreme reserves the right to substitute materials at anytime. Standard/Optional features may change without notice. REV 1.1.24