

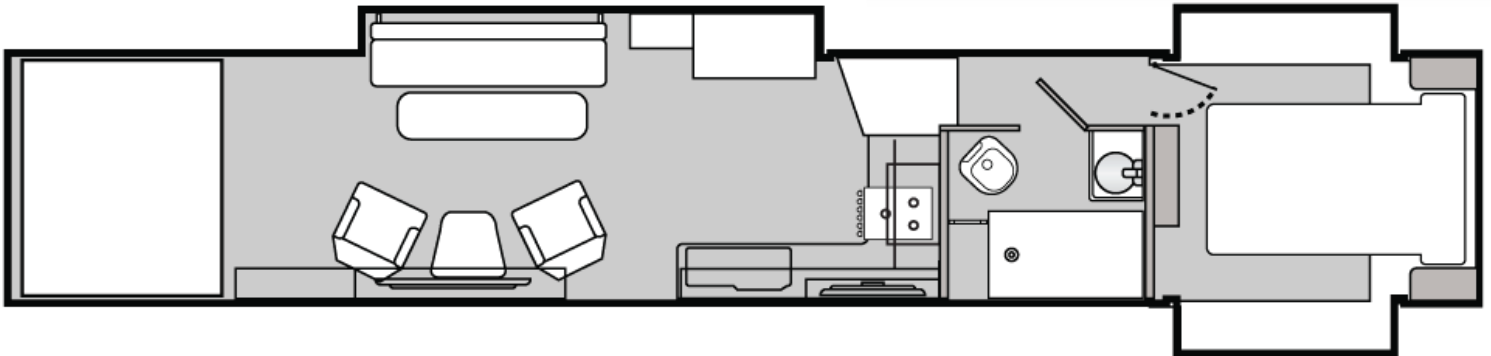

R3917KDTS SPEC SHEET



Supreme Package - Includes:

- Dual landing gear motors with dual switch
- 7000 lb triple Axels with 16" wheels/G Rated Tires
- 40-Gallon Fuel Station
- External 110v Electrical Outlets
- Spare Tire & Carrier

Premier Package

- 8-Foot Laminated Ramp Door w/Beaver Tail
- Hi-Gloss Grey Fiberglass Sidewalls, Aluminum-Framed & Laminated
- Large Designer Front Cap w/LED's
- Exterior Folding Ladder w/ Walk-on Roof
- 10-Gallon Two-Way 110V / LP DSI Water Heater
- Sewer Hose Compartment
- LED Exterior Flood Lights
- LED Exterior Running Lights & Tail Lights

Deluxe Package

- Power Sofa Bed (Rear) & Upper Bunk(Powered) Shower & Glass Enclosure
- Sofa/Galley Living Room Slideout
- Stainless Deep Galley Sink w/Pull-Down Faucet
- Microwave(Extra Large Over-the-Range Residential)
- Fireplace / 110V Heater in Bedroom w/Entertainment Ctr
- Exterior TV Bracket & Hookups
- RV "T" King Memory Foam Mattress w/ Coordinated Bedspread
- USB 12V Chargers (3)
- Black Roller Shades Throughout
- Solid Surface Galley/Lavy Counter Top w/Covers

UNIT SPECS

OVERALL LENGTH	39'10"
GVWR (lbs)	17,500
DRY WEIGHT (lbs)	13,180
HITCH WEIGHT (lbs)	3,290
AXLE WEIGHT (lbs)	9,890
AXLE CAPACITY (lbs) (triple axle)	7,000
CARGO CAPACITY (lbs)**	4,320
TIRE SIZE	16"
FRESH WATER (GAL)	160
GRAY WATER (GAL)	50
BLACK TANK (GAL)	50

Note: Weights may change due to options added.

Options:

- Power & Cooling Upgrade Pkg*
- Hi Eff. Power & Cooling Upgrade Pkg****
- Hydraulic Jacks (Forced Option) — X
- Roadside & Doorside Duo Vanity & Wardrobe Slide Outs
- Patio Railing System
- Rear Power Patio Awning
- Wireless Back up Camera
- Triple 8,000lb Axles
- Door Refrigerator 12V 15.6 CU. FT.W/1 Add'l Solar Panel
- Residential Refer W/1 Add'l Solar Panel
- Generator Auto Command (Forced Option W/Residential)
- Central Vacuum System
- Opposing Rear Power Dinn's
- Rear 32" TV W/Ent. Center
- 2nd Grey Tank
- Regular Windows IPO STD Single Pane Frameless
- Upgraded vent in Lavy
- Upgraded vent in Rear
- Upgraded vent Bedroom
- Stainless Steel Galley Package
- Supreme Package (Forced Option) — X
- Premier Package (Forced Option) — X
- Deluxe Package (Forced Option) — X
- Dual Pane Frameless Windows
- Double Insulated Roof
- Arctic Package**
- Cable Kit
- Winterized
- (2) 200W Solar w/1500W pass through Inverter — X (Forced W/Residential)
- Tool Box
- Sidewalls Sunsatation Glass(Forced Option) — X
- Wi-Fi Ready (Forced Option) — X
- Upgraded Graphics Pkg (Req'd) — X
- Upgrade Package (Req'd) — X
- Rear Pull Down Screen
- 12V Air Compressor (Forced Option) — X

Standard Features - Included in Base Price

- Upgraded Hitch Roto flex
- 102" Wide Body Design
- Entry door w/Keyless Remote entry
- Fold Down Stairs w/Folding Entry DR Handle
- RS bed ward slide with mirrored doors
- DS bed slide with XL vanity top with 4 large drawers
- Chef inspired style Range with glass folding cover
- (1) Living Room 50" TV
- 8 cu Refer in slide out
- Stylish ceiling lighted soffit
- Upgraded Home Style furniture
- 2 Euro Style reclining chairs W/foot rest and Table(black only)
- 40" Bedroom TV w/Swivel Bracket
- Stylish and Powerful 110 Ceiling Fan
- Upgraded vent in Galley
- Hidden cabinet door hinges
- Single pane Frameless windows
- EZ Flex Suspension
- 4.0 KW ONAN Generator w/Transfer Switch
- A/C 15.0K BTU w/Ducting
- Flat Floor Wall-to-Wall) No wheel wells
- 68" sofa in main slide out with table
- 30,000 BTU Furnace
- One-Piece PVC Vinyl Roof
- Slam-Door Luggage Compartments
- Dual 30 Lbs LP Tanks
- Rear Spoiler
- Rear Screen Wall
- Metal Lavy Sink w/Stylish metal faucet
- TV Antenna w/Cable & Satellite Hook-Up
- Skylight Above Shower
- Carpet Kit
- Bunk Ladder
- Plumbed for Exterior LP Hookup
- LED Rope Lights/Living Room Valances(2 valances)
- LED Interior Lighting Throughout
- 12v power vent bathroom
- Roof vent bunk area
- Stylish décor lighting in bedroom
- Rear Back up lights with side blinkers
- Stereo AM/FM/CD/DVD w/Bluetooth/USB & Subwoofer
- Power Awning w/LED Light Strip
- Exterior 40" TV w/Cabinet & Luggage Door

* Includes 5.5KW Onan Generator Upgrade, 13.5K BTU Bedroom A/C, 50 Amp Service.

** Includes Heated Enclosed Tanks/Valves, Reflected Floor Insulation, Heat Ducting System For Furnace, Double Insulation in Ceiling.

**** Includes 5.5KW Onan Generator Upgrade, W/3 each HI EFF 13.5K BTU AC's (Bedroom-galley(ducted)Rear), with 50 Amp Service

Note: Due to possible changes from suppliers, Genesis Supreme reserves the right to substitute materials at anytime. Standard/Optional features may change without notice.