

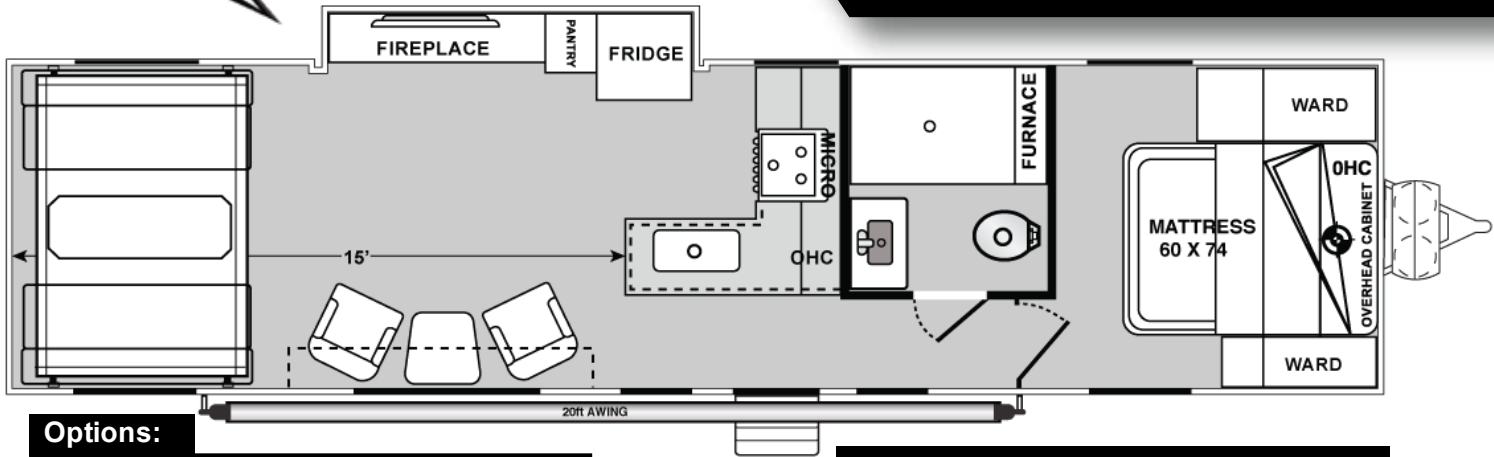

R3215FSXL SPEC SHEET



Options:

- Power & Cooling Upgrade Pkg*
- Wireless Back up Camera
- Power Stab Jacks
- TV - Bedroom (32")
- RV King Mattress
- Double Door Refrigerator 12V 15.6 CU. FT. W/1 Addtl Solar Panel (Pantry Delete)
- Stainless Steel Galley Package
- Rear Screen Wall
- EZ Flex Suspension (Triple)
- 1500W Pass Thru Inverter
- Exterior Premier Package (Forced Option) X**
- Interior Deluxe Package (Forced Option) X**
- Arctic Package**
- Comfort Package***
- Double Insulated Roof
- Patio Cables
- 12V Air Compressor
- Winterized
- Fold Down Stairs w/Fold Entry DR Handle
- Sidewalls Sunsatation Glass(Forced Option) X**
- Patriotic Pkg
- Pacific West Associates Tag Req'd X**
- RVIA Tag Req'd X**

Exterior Premier Package

- 40-Gallon Fuel Station
- 15K BTU Air Conditioner w/Ducting
- Spare Tire & Carrier
- Stylish Fiberglass Front Cap with LED Lighting
- Power Awning IPO STD
- 6,000lb Axle w/F Rated Tires (Triple)**
- Front Power Jack
- Walk-on Roof w/Folding Ladder
- 200W Solar Panel**

Interior Deluxe Package

- Three-Burner Stove w/Oven
- Shower & Glass Enclosure**
- AM/FM/CD/DVD Player w/4 Inside/2 Outside Speakers
- LED Interior Lighting Throughout
- Magazine Rack & Key Hooks
- Solid Surface galley top with sink covers
- Upgraded Furniture
- 10 Cubic Refrigerator 12V
- Night Shades
- Wifi Ready

UNIT SPECS

OVERALL LENGTH	36'6"
ROADSIDE CARGO	15'
DOORSIDE CARGO	15'
GVWR (lbs)	13,000
DRY WEIGHT (lbs)	9,332
HITCH WEIGHT (lbs)	1,282
AXLE WEIGHT (lbs)	8,050
AXLE CAPACITY (lbs) Triple Axle	6000
CARGO CAPACITY (lbs)	3,668
TIRE SIZE	15"
FRESH WATER (GAL)	100
GRAY WATER (GAL)	40
BLACK TANK (GAL)	40

Note: Weights may change due to options added.

Standard Features - Included in Base Price

- 102" Wide-Body Design
- Grey Fiberglass Laminated Aluminum-Framed Sidewalls
- 7-Foot Ramp Door w/Full-Length Latches
- 100 Gallons Fresh Water
- Dual 30-LB Propane Tanks w/Deluxe Cover**
- Microwave
- Pillow Top Mattress w/ Bedspread
- Exterior Shower (Hot & Cold)
- Extra-Large Windows (Radius & Tinted) & Valances
- Black Tank Flush
- Stainless Steel Galley Sink w/High-Rise Metal Faucet
- 6-Gallon Gas DSI Water Heater**
- Inset Coffered Ceiling Panel w/LED & Accent Lights
- 30K Furnance
- 15" Alum Wheels
- Lavy Sink w/Medicine Cabinet
- Seamless One-Piece Rubber Roof
- 10" I Beam Frame**
- Above-Cabinet Storage w/Chrome Storage Bars
- 12v Powered Fan Roof Vents (Galley, Lavy)
- TV Antenna
- Sewer Hose Storage Compartment
- External 110v Electrical Outlets
- Exterior Metal Diamond Plate Front & Skirting
- Plumbed for Exterior LP Hookup
- Double Radius Entry Door Step
- Exterior Lights - Porch (2), Rear (2), Front (1)
- Tie-Downs Throughout
- Four (4) Stab Jacks
- Roof Vents (Bunk Area & Bedroom)
- Rear Spoiler
- 4.5KW YAMAHA Generator w/Transfer Switch**
- Opposing Rear Power Dinette**
- Two (2) Swivel Rockers**
- Slide-Out Living Room**
- Entertainment Center w/ 50" TV and Fireplace**
- Over the Range Microwave-Large**

Power & Cooling Upgrade Pkg* Includes 6.0KW Yamaha Generator Upgrade, 13.5K BTU Bedroom A/C(w/wall control), **50 Amp Service**

Arctic Package** Includes Heated Enclosed Tanks, Reflected Floor Insulation, Heat Ducting System For Furnace, Double Insulation in Ceiling

Comfort Pkg*** Includes 2 - AC 13.5k BTU (Bedroom & Livingroom) w/Ducting IPO 15.0k w/Ducting

Note: Due to possible changes from suppliers, Genesis Supreme reserves the right to substitute materials at anytime. Standard/Optional features may change without notice. REV 1.1.24