

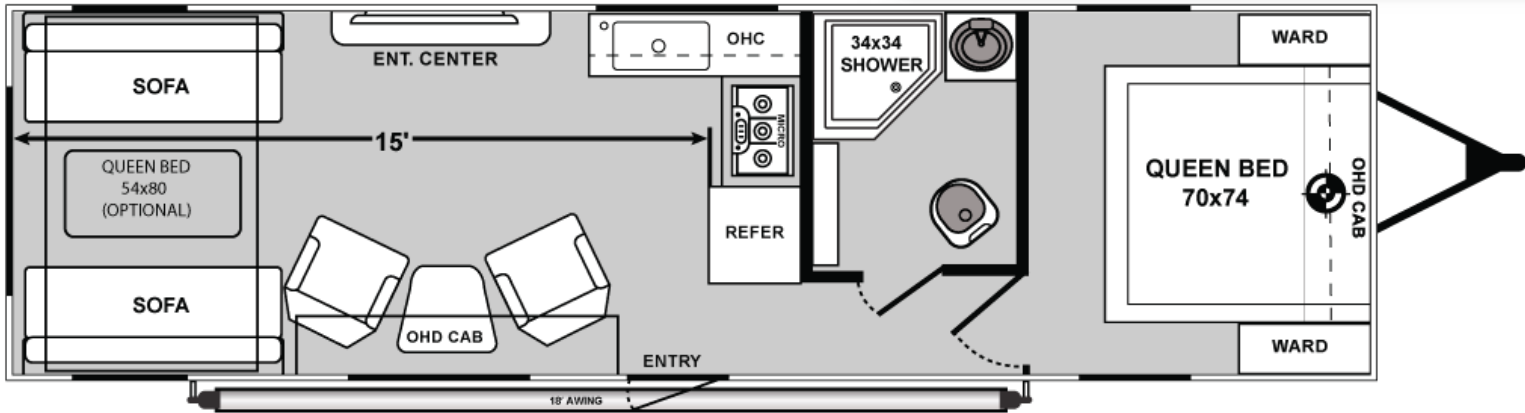

R275CRXL SPEC SHEET



Exterior Deluxe Package

- 6-Gallon Gas Water Heater
- 30K Furnance
- Front Power Jack
- Power Awning w/LED Strip
- 200W Solar Panel
- Stab Jacks (4)
- Exterior Lights - Porch (1), Rear (2), Front (1)

Interior Deluxe Package

- 10 cu. 12V Dual Swing Refrigerator
- AM/FM/CD/DVD Player w/
- 2 Inside/2 Outside Speakers
- LED Interior Lighting
- Nite Shades
- Black microwave .9
- 13.5K BTU Air Conditioner
- Pillow top mattress w/bedspread

Options:

- 4.5KW YAMAHA Generator w/Transfer Switch
- 40 Gallon Fuel Station
- 6,000lb Axle Upgrade w/F Rated Tires** — X
- (Forced Option)**
- Front Cap Fiberglass **(Forced Option)** — X
- RV King Mattress (Master bedroom)
- Opposing Rear Power Dinette W/Single Bed
- IPO Sofa **(Forced Option)** — X
- Exterior Premier Package(Forced Option)** — X
- Interior Deluxe Package (Forced Option)** — X
- Double Insulated Roof
- Arctic Package*
- 15.0K BTU A/C Living Room (IPO 13.5K)
- Patio Cables
- 12V Air Compressor
- Fold Down Stairs w/Fold Entry DR Handle
- Winterized
- Sidewalls Sunsation Glass (Forced Option)** — X
- Pacific West Associates Tag Req'd** — X
- RVIA Tag Req'd** — X

Arctic Package* Includes Heated Enclosed Tanks, Reflected Floor Insulation, Heat Ducting System For Furnace, Double Insulation in Ceiling.

Note: Due to possible changes from suppliers, Genesis Supreme reserves the right to substitute materials at anytime. Standard/Optional features may change without notice.

REV 1.1.24

Standard Features - Included in Base Price

- 8"inch High Beam (Chassis)
- 102" Wide-Body Design
- 5200 dual axels
- 15' Black Steel Rims E Rated Tires
- 7-Foot Ramp Door
- Grey Fiberglass Laminated Aluminum -Framed Sidewalls**
- Spare Tire & Carrier
- Dual 20-LB Propane Tanks w/Deluxe Cover
- 3 - Burner Cooktop**
- Corner Shower w/ Glass door, Surround
- Solid Surface Counter Top Galley with Lights**
- Exterior Shower (Hot & Cold)
- Extra-Large Windows (Radius & Tinted) & Valances
- Black Tank Flush
- Stainless Steel Galley Sink w/pull out SS faucet
- Two (2) Swivel Rockers
- Entertainment Center w 40" TV and Fireplace**
- Deluxe Accent Lights w/Soffit**
- Lavy Sink w/Medicine Cabinet
- Seamless One-Piece Rubber Roof
- (2) Fold Up Sofa's w/ Single Electric Bed and Bunk Ladder**
- 12v Powered Fan Roof Vents (Galley, Lavy)
- Key Hooks
- TV Antenna
- Sewer Hose Storage Compartment
- External 110v Electrical Outlet
- Pebble Finish Skirting
- Triple Radius Entry Door Step
- Tie-Downs Throughout
- Roof Vents (Bunk Area & Bedroom)
- Rear Spoiler
- Front Wrap w/ Diamond Plate
- Large folding table at Sofas
- Flat floor interior no wheel wells
- Driver Side Flip Up Table
- Single Bowl Kitchen Sink**

UNIT SPECS

OVERALL LENGTH	32'9"
GVWR (lbs)	11,500
DRY WEIGHT (lbs)	7,891
HITCH WEIGHT (lbs)	1,366
AXLE WEIGHT (lbs)	6,525
AXLE CAPACITY (lbs)	6,000
CARGO CAPACITY (lbs)	3,609
TIRE SIZE	15"
FRESH WATER (GAL)	100
GRAY WATER (GAL)	40
BLACK TANK (GAL)	40
Note: Weights may change due to options added.	