

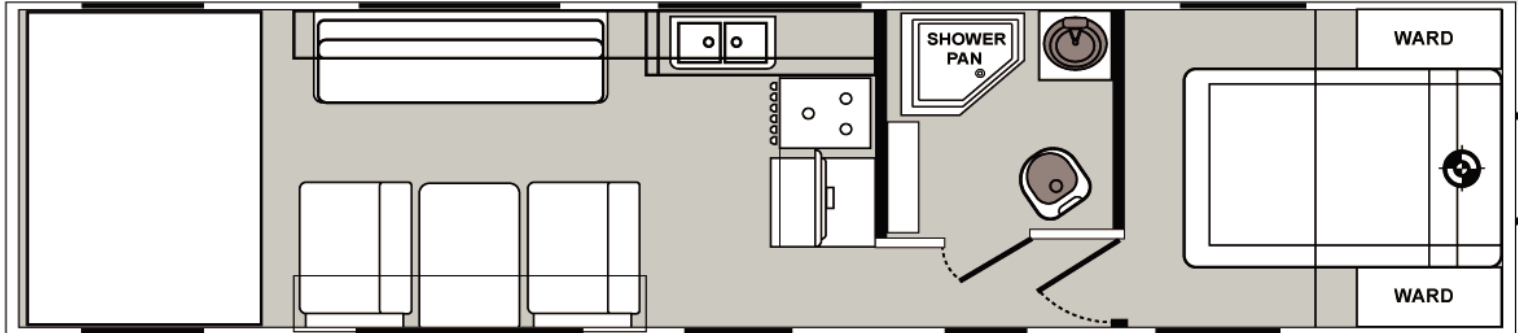

# R2715FSXL SPEC SHEET



## Options:

- 4.5KW YAMAHA Generator w/Transfer Switch
- Wireless Back up Camera
- Power Stab Jacks
- TV - Bedroom (32")
- RV King Mattress
- Opposing Rear Power Dinette IPO Power Lower Bed
- Two (2) Swivel Rockers IPO Dinette
- Slide-Out Living Room
- Entertainment Center w/ 50" TV and Fireplace IPO Sofa
- Power Sofa Bed (Rear)
- Over the Range Microwave-Large
- Stainless Steel Galley Package
- Rear Screen Wall
- EZ Flex Suspension
- Exterior Premier Package (Forced Option)** — X
- Interior Deluxe Package (Forced Option)** — X
- Arctic Package\*
- Comfort Package\*\*
- Double Insulated Roof
- Patio Cables
- 12V Air Compressor
- Winterized
- Fold Down Stairs w/Fold Entry DR Handle
- Patriotic Pkg
- Sidewalls Sunsation Glass(Forced Option)** — X
- Pacific West Associates Tag Req'd** — X
- RVIA Tag Req'd** — X

## Exterior Premier Package

- 40-Gallon Fuel Station
- 15K BTU Air Conditioner w/Ducting
- Spare Tire & Carrier
- Stylish Fiberglass Front Cap with LED Lighting
- Power Awning IPO STD
- 6,000lb Axle w/F Rated Tires (Triple)**
- Front Power Jack
- Walk-on Roof w/Folding Ladder
- 200W Solar Panel**

## Interior Deluxe Package

- Three-Burner Stove w/Oven
- Radius Glass Corner Shower Enclosure
- AM/FM/CD/DVD Player w/4 Inside/2 Outside Speakers
- LED Interior Lighting Throughout
- Magazine Rack & Key Hooks
- Solid Surface galley top with sink covers
- Upgraded Furniture
- TV - Living Room (32")
- 10 Cubic Refrigerator 12V
- Night Shades
- Wifi Ready

**Arctic Package\*** Includes Heated Enclosed Tanks, Reflected Floor Insulation, Heat Ducting System For Furnace, Double Insulation in Ceiling.

**Comfort Pkg\*\*** Includes 2 - AC 13.5k BTU (Bedroom & Livingroom) w/Ducting IPO 15.0k w/Ducting.

## Standard Features - Included in Base Price

- 102" Wide-Body Design
- Grey Fiberglass Laminated Aluminum-Framed Sidewalls
- 7-Foot Ramp Door w/Full-Length Latches
- 100 Gallons Fresh Water
- Powered Rear Queen Beds (Two)
- Dual 20-LB Propane Tanks w/Deluxe Cover
- Microwave
- Pillow Top Mattress w/ Bedspread
- Exterior Shower (Hot & Cold)
- Extra-Large Windows (Radius & Tinted) & Valances
- Black Tank Flush
- Stainless Steel Galley Sink w/High-Rise Metal Faucet
- 6-Gallon Gas DSI Water Heater
- Inset Coffered Ceiling Panel w/LED & Accent Lights
- 30K Furnace
- 15" Alum Wheels
- Lavy Sink w/Medicine Cabinet
- Seamless One-Piece Rubber Roof
- Dinette with Table, and One Sofa, 8" I Beam Frame
- Above-Cabinet Storage w/Chrome Storage Bars
- 12v Powered Fan Roof Vents (Galley, Lavy)
- TV Antenna
- Sewer Hose Storage Compartment
- External 110v Electrical Outlets
- Exterior Metal Diamond Plate Front & Skirting
- Plumbed for Exterior LP Hookup
- Double Radius Entry Door Step
- Exterior Lights - Porch (2), Rear (2), Front (1)
- Tie-Downs Throughout
- Four (4) Stab Jacks
- Roof Vents (Bunk Area & Bedroom)
- Rear Spoiler

## UNIT SPECS

OVERALL LENGTH	32' 9"
GVWR (lbs)	11,500
DRY WEIGHT (lbs)	7,460
HITCH WEIGHT (lbs)	1,320
AXLE WEIGHT (lbs)	6,140
AXLE CAPACITY (lbs)	6,000
CARGO CAPACITY (lbs)	4,040
TIRE SIZE	15"
FRESH WATER (GAL)	100
GRAY WATER (GAL)	40
BLACK TANK (GAL)	40
Note: Weights may change due to options added.	

Note: Due to possible changes from suppliers, Genesis Supreme reserves the right to substitute materials at anytime. Standard/Optional features may change without notice.