

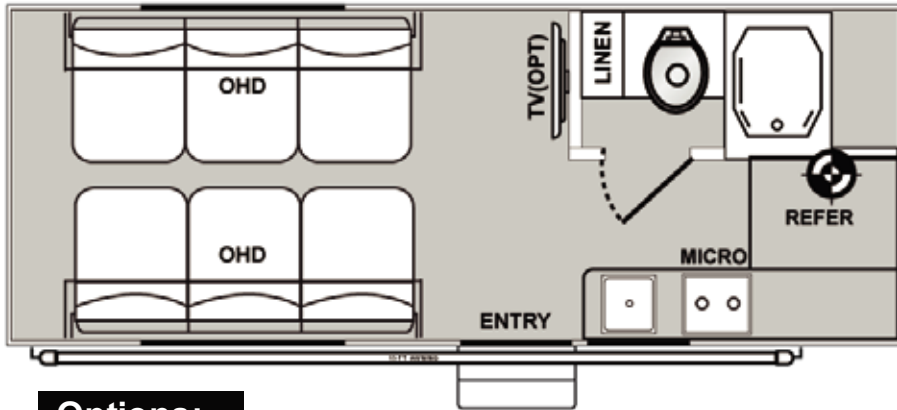

B155LTE SPEC SHEET



UNIT SPECS

OVERALL LENGTH	20'-1"
ROADSIDE CARGO LENGTHV	21'
GVWR (lbs)	6,500
DRY WEIGHT (lbs)	3933
HITCH WEIGHT (lbs)	768
AXLE WEIGHT (lbs)	3165
AXLE CAPACITY (lbs)	3500
CARGO CAPACITY (lbs)	2567
TIRE SIZE	14"
FRESH WATER (GAL)	50
GRAY WATER (GAL)	26
BLACK TANK (GAL)	26

Note: Weights may change due to options added.

Options:

Aluminum Wheels IPO Black Steel	
Front Power Jack (Forced Option)	X
200W Solar Panel (Forced Option)	X
Double Insulated Roof	
Exterior Premier Package(Forced Option)	X
Interior Deluxe Package(Forced Option)	X
Arctic Package*	
15.0K BTU A/C Living Room (IPO 13.5K)	
TV - Living room (24")	
Drive On Wheel Well	
Winterized	
Cool Grey Exterior Sidewalls IPO White	
Sidewalls Sunsatation Glass(Forced Option)	X
Patriotic Package	
Pacific West Associates Tag Req'd	X
RVIA Tag Req'd	X
Retractable Shower Door(Forced Option)	X

Interior Package

Black microwave .9
RTF Countertop
Large Double Door Refrigerator (8 Cubic Foot)
18K Furnance
Key Hooks
Nite Shades

Exterior Package

Power Awning w/LED Strip
Sewer Hose Storage Compartment
Four (4) Stab Jacks rear/ front
Spare Tire & Carrier
14" Black Steel Rims D Rated Tires
6-Gallon Gas Water Heater

Standard Features - Included in Base Price

6" inch High Beam(Chassis)
84" Wide- Design
3500 dual axels
White Fiberglass Laminated Aluminum-Framed Sidewalls
13.5K BTU Air Conditioner
75" Ramp Door White
Dual 20-LB Propane Tanks w/Deluxe Cover
2 - Burner Cooktop
Storage Shelf
Tub/Shower Surround
Extra-Large Windows(Radius & Tinted) & Valances
Black Tank Flush
Stainless Steel Galley Sink w/pull out faucet
Equipped w/ BT and Upgraded Speakers
LED Interior Lighting
Seamless One-Piece Rubber Roof
Fold Up Sofa's (2)
12v Powered Fan Roof Vents (Lavy)
TV Antenna
External 110v Electrical Outlet
Metal Skirting
Double Radius Entry Door Step
Exterior Lights - Porch (1), Rear (2), Front (1)
Tie-Downs Throughout
Ceiling Roof Vent
Rear Spoiler
Front Wrap w/ Diamond Plate
Large Table between Sofa's
Spray Away
Dump Station Light

Arctic Package* Includes Heated Enclosed Tanks, Reflected Floor Insulation, Heat Ducting System For Furnace, Double Insulation in Ceiling

Note: Due to possible changes from suppliers, Genesis Supreme reserves the right to substitute materials at anytime. Standard/Optional features may change without notice. REV 1.1.24