

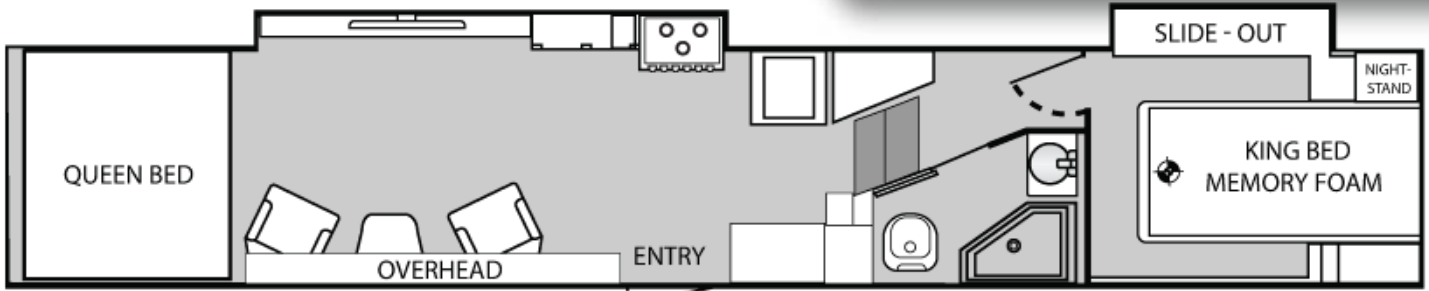

# R335CKG SPEC SHEET



### Options:

- Power & Cooling Upgrade Pkg\*
- Hydraulic Jack
- Upgraded Hitch Roto Flex(Forced Option) — X
- Living Room Galley Slideout
- Patio Railing System
- Euro Chairs (Forced Option) — X
- Opposing Rear Power Dinette
- Rear Power Patio Awning
- Wireless Back up Camera
- Dual 8,000 lb Axles
- 200W Solar w/1500W Pass Thru Inverter
- 4 Door Refer Gas/Elec w/Panel Inserts
- Residential Refer W/1 Addt'l Solar Panel
- Auto Command Gen Start (Forced w/Residential)
- Stainless Steel Galley Package
- Supreme Package(Forced Option) — X
- Premier Package(Forced Option) — X
- Deluxe Package(Forced Option) — X
- Central Vacuum System
- Keyless / Remote Entry Lock
- Frameless Dual-Pane Windows
- 2nd Grey Tank
- USB 12V Charger Addt'l
- EZ Flex Suspension
- Upgraded Fan w/Remote ( Lavy )
- Upgraded Fan w/Remote(Rear or Bedroom)
- Arctic Package\*\*
- Double Insulated Roof
- Cable Kit
- Winterized
- Tool Box
- Rear Pull Down Screen Wall
- 12V Air Compressor
- Fold Down Stairs w/Fold Entry DR Handle
- Patriotic Pkg (Must Choose a Graphic Base Color)
- Sidewalls Sunation Glass(Forced Option) — X
- Wi-Fi Ready (Forced Option) — X
- Grey Skirting (Forced Option) — X
- Glass Top Stove (Forced option) — X

### Standard Features - Included in Base Price

- Slideout Duo Vanity/Wardrobe in Bedroom
- 4.0 KW ONAN Generator w/Transfer Switch
- A/C 15.0K BTU w/Ducting
- 102" Wide Body Design
- Flipped Axles w/No Wheelwells (Flat Floor Wall-to-Wall)
- 16" Deluxe Aluminum Alloy Wheels
- Two Swivel/Rocker Chairs w/Table
- Rear Table and Legs
- Living Room 50" TV W/Swivel Bracket
- 40" Bedroom TV W/Swivel Bracket
- Luxury Galley Top Extension
- Inset Coffered Ceiling Panel w/LED & Accent Lights
- Counter-Top Edge LED Lighting - Switched
- Power Awning w/LED Light Strip
- 30,000 BTU Furnace
- Slam-Door Luggage Compartments
- One-Piece PVC Vinyl Roof
- Stereo AM/FM/CD/DVD w/Bluetooth/USB
- Extra-Large Double Door Refrigerator(10 Cu. Ft.)W/Dual Hinge
- Stylish Entertainment Center w/50" TV in Living Room Slide
- 40" Fireplace 110V Heater in Living Room Slide
- Rear Spoiler
- Ceiling Fan
- Rear Screen Wall
- Metal Lavy Sink w/stylish faucet
- Three-Burner Range w/Oven
- Spray Away
- TV Antenna w/Cable & Satellite Hook-Up
- Two (2) Stab Jacks (Rear)
- 12V Powered Fan Roof Vent - Lavy
- Roof Vent (Bunk Area)
- Skylight Above Shower
- Black Tank Flush
- Carpet Kit
- Bunk Ladder
- Plumbed for Exterior LP Hookup
- LED Rope Lights/Living Room Valances
- LED Interior Lighting Throughout
- Dual 30 Lbs LP Tanks
- 30" Fireplace 110V Heater in Bedroom
- T-King Walk around bed

### Supreme Package - Includes:

- Dual landing gear motors with dual switch
- 7000 lb Dual Axles with 16" wheels/
- 40-Gallon Fuel Station G Rated Tires
- External 110v Electrical Outlets
- Spare Tire & Carrier

### Premier Package

- 8-Foot Laminated Ramp Door w/Beaver Tail
- Hi-Gloss Grey Fiberglass Sidewalls,Aluminum
- Framed & Laminated
- Large Designer Front Cap w/LED's
- Exterior Folding Ladder w/ Walk-on Roof
- 10-Gallon Two-Way 110V / LP DSI Water Heater
- Sewer Hose Compartment
- LED Exterior Flood Lights
- LED Exterior Running Lights & Tail Lights

### Deluxe Package

- Power Sofa Bed(Rear)& Upper Bunk(Powered)
- Shower & Glass Enclosure
- Stainless Deep Galley Sink w/Pull-Down Faucet
- Microwave(Extra Large Over-the-Range Residential)
- Exterior TV Bracket & Hookups
- RV "T" King Memory Foam Mattress w/
- Coordinated Bedspread
- USB 12V Chargers (3)
- Black Roller Shades Throughout
- Solid Surface Galley Counter Top w/Covers

### UNIT SPECS

OVERALL LENGTH	36' 10"
GVWR (lbs)	15,000
DRY WEIGHT (lbs)	12,080
HITCH WEIGHT (lbs)	3,050
AXLE WEIGHT (lbs)	9,030
AXLE CAPACITY (lbs)	7,000
CARGO CAPACITY (lbs)**	2,920
TIRE SIZE	16"
FRESH WATER (GAL)	160
GRAY WATER (GAL)	50
BLACK TANK (GAL)	50

Note: Weights may change due to options added.

\* Includes 5.5KW Onan Generator Upgrade, 13.5K BTU Bedroom A/C w/wall control- 50 Amp Service.

\*\* Includes Heated Enclosed Tanks/Valves, Reflected Floor Insulation, Heat Ducting System For Furnace, Double Insulation in Ceiling