

## 40GSXL

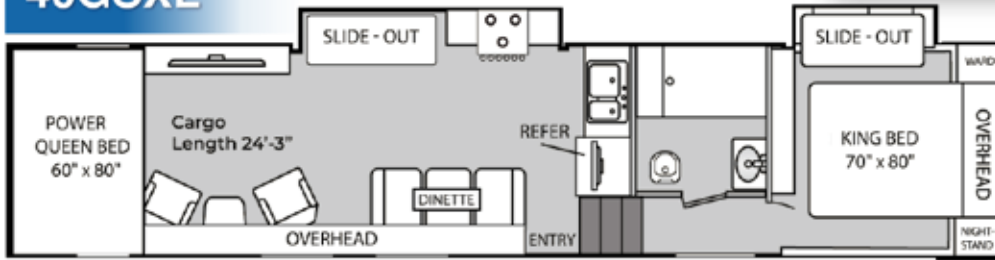

OVERALL LENGTH	GVWR	DRY WEIGHT	HITCH WEIGHT	AXLE WEIGHT	CAPACITY		TIRE SIZE	WATER		
					AXLE	CARGO		FRESH	GRAY	BLACK
42'-5"	18,000	13,700	3,060	10,640	7,000	4,300	16"	160	50	50
LBS							GAL			

### UNIT SPECS

OVERALL LENGTH	42' 5"
GVWR (lbs)	18,000
DRY WEIGHT (lbs)	13,700
HITCH WEIGHT (lbs)	3,060
AXLE WEIGHT (lbs)	10,640
AXLE CAPACITY (lbs)	7,000
CARGO CAPACITY (lbs)**	4,300
TIRE SIZE	16"
FRESH WATER (GAL)	160
GRAY WATER (GAL)	50
BLACK TANK (GAL)	50
Note: Weights may change due to options added.	

### Supreme Package - Includes:

- i) Dual landing gear motors with dual switch
- ii) 7000 lb Triple Axels with 16" wheels/G Rated Tires
- iii) 40-Gallon Fuel Station
- iv) External 110v Electrical Outlets
- v) Spare Tire & Carrier

### Premier Package

- i) 8-Foot Laminated Ramp Door w/Beaver Tail
- ii) Hi-Gloss Fiberglass Sidewalls, Aluminum-Framed & Laminated
- iii) Large Designer Front Cap w/LED's
- iv) Exterior Folding Ladder w/ Walk-on Roof
- v) 10-Gallon Two-Way 110V / LP DSI Water Heater
- vi) Sewer Hose Compartment
- vii) LED Exterior Flood Lights
- viii) LED Exterior Running Lights & Tail Lights

### Deluxe Package

- i) Power Sofa Bed (Rear) & Upper Bunk (Power)
- ii) Shower & Glass Enclosure
- iii) Sofa/Galley Living Room Slideout
- iv) Stainless Deep Galley Sink w/Pull-Down Faucet
- v) Microwave (Extra Large Over-the-Range Residential)
- vi) Fireplace / 110V Heater in Bedroom w/Entertainment Ctr
- vii) RV King Memory Foam Mattress w/Coordinated Bedspread
- viii) USB 12V Chargers (3)
- ix) Pleated Night Shades Throughout
- x) Solid Surface Galley Counter Top w/Covers

### Options:

- Power & Cooling Upgrade Pkg\*
- Hi Eff** Power & Cooling Upgrade Pkg\*\*\*\*
- Hydraulic Jack Forced Option**
- Upgraded Hitch Roto Flex(Forced Option)**
- Queen Bed Memory Foam
- Patio Railing System
- Euro Chairs (Forced Option)**
- Opposing Rear Power Dinette
- Rear Power Patio Awning
- Wireless Back up Camera
- Triple 8,000 lb Axles
- 190W Solar w/2000W Pass Thru Inverter
- 4 Door Refer Gas/Elec w/Panel Inserts
- Residential Refer W/1 Addtl Solar Panel
- Generator Auto Command (Forced Option w/Res Pkg)
- Secondary Fuel Tank w/Pump Station
- Stainless Steel Galley Package
- Supreme Package (Forced Option)**
- Premier Package (Forced Option)**
- Deluxe Package (Forced Option)**
- Central Vacuum System
- Keyless / Remote Entry Lock
- Coffee Maker Stand in Galley
- Frameless Dual-Pane Windows
- Double Insulated Roof
- 2nd Grey Tank
- Upgraded Fan w/Remote (Lavy)
- Upgraded Fan w/Remote (Rear or Bedroom)
- Arctic Package\*\*
- Cable Kit
- Winterized
- Tool Box
- Fold Down Stairs w/Fold Entry DR Handle
- Patriotic Pkg (Must Choose a Graphic Base Color)
- Wi-Fi Ready (Forced Option)**
- Pacific West Associates Tag (Req'd)**
- RVIA Certification Tag (Req'd)**

### Standard Features - Included in Base Price

- Glass-Top Stainless Range
- Counter-Top Edge LED Lighting - Switched
- Exterior 40" TV w/Cabinet & Luggage Door
- Stereo AM/FM/CD/DVD w/Bluetooth/USB & Subwoofer
- Large Stainless Steel Backsplash
- EZ Flex Suspension
- Slideout Duo Vanity/Wardrobe in Bedroom
- 4.0 KW ONAN Generator w/Transfer Switch
- A/C 15.0K BTU w/Ducting
- 102" Wide Body Design
- Flipped Axles w/No Wheelwells (Flat Floor Wall-to-Wall)
- 16" Deluxe Aluminum Alloy Wheels
- Two Swivel/Rocker Chairs w/Table, Dinette, Slide-out Sofa Bed
- Rear Table and Legs
- (2) Living Room 40" TV w/Swivel Bracket
- 32" Bedroom TV w/ Swivel Bracket
- Inset Coffered Ceiling Panel w/LED & Accent Lights
- 30,000 BTU Furnace
- Dual 30 Lbs LP Tanks
- Extra-Large Double Door Refrigerator (8 Cu. Ft.)
- Rear Spoiler
- Ceiling Fans (Two in Living Room)
- Rear Screen Wall
- Metal Lavy Sink w/Stainless Backsplash
- Exterior Shower (Hot & Cold Water)
- TV Antenna w/Cable & Satellite Hook-Up
- Two (2) Stab Jacks (Rear)
- 12v Powered Fan Roof Vent - Lavy
- Roof Vent (Bunk Area)
- Skylight Above Shower
- Black Tank Flush
- Carpet Kit
- Bunk Ladder
- Plumbed for Exterior LP Hookup
- LED Rope Lights/Living Room Valances
- LED Interior Lighting Throughout
- Power Awning w/LED Light Strip
- One-Piece PVC Vinyl Roof
- Slam-Door Luggage Compartments

\* Includes 5.5KW Onan Generator Upgrade, 13.5K BTU Bedroom A/C w/wall control, 50 Amp Service.

\*\* Includes Heated Enclosed Tanks/Valves,Reflected Floor Insulation, Heat Ducting System For Furnace,Double Insulation in Ceiling.

\* Includes 5.5KW Onan Generator Upgrade, W/3 each **HI EFF** 13.5K BTU AC's (Bedroom-galley(ducted)Rear),with 50 Amp Service

Note: Due to possible changes from suppliers, Genesis Supreme reserves the right to substitute materials at anytime.Standard/Optional features may change without notice.