

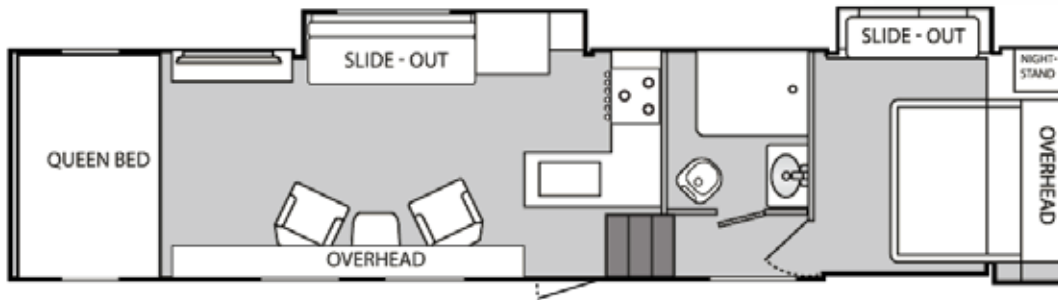

# 3818RIKS SPEC SHEET



UNIT SPECS	
OVERALL LENGTH	39'10"
ROADSIDE CARGO	17'
DOORSIDE CARGO	18'
GVWR (lbs)	17,500
DRY WEIGHT (lbs)	12,640
HITCH WEIGHT (lbs)	2,990
AXLE WEIGHT (lbs)	9,650
AXLE CAPACITY (lbs) Triple axle	7000
CARGO CAPACITY (lbs)**	4,860
TIRE SIZE	16"
FRESH WATER (GAL)	160
GRAY WATER (GAL)	50
BLACK TANK (GAL)	50

Note: Weights may change due to options added.

- Supreme Package - Includes:**
- i) Dual landing gear motors with dual switch
  - ii) 7000 lb Triple Axels with 16" wheels/G Rated Tires
  - iii) 40-Gallon Fuel Station
  - iv) External 110v Electrical Outlets
  - v) Spare Tire & Carrier

- Premier Package**
- i) 8-Foot Laminated Ramp Door w/Beaver Tail
  - ii) Hi-Gloss Fiberglass Sidewalls, Aluminum-Framed & Laminated
  - iii) Large Designer Front Cap w/LED's
  - iv) Exterior Folding Ladder w/ Walk-on Roof
  - v) 10-Gallon Two-Way 110V / LP DSI Water Heater
  - vi) Sewer Hose Compartment
  - vii) LED Exterior Flood Lights
  - viii) LED Exterior Running Lights & Tail Lights

- Deluxe Package**
- i) Power Sofa Bed (Rear) & Upper Bunk (Power)
  - ii) Shower & Glass Enclosure
  - iii) Stainless Deep Galley Sink w/Pull-Down Faucet
  - iv) Microwave (Extra Large Over-the-Range Residential)
  - v) Exterior TV Bracket & Hookups
  - vi) RV King Memory Foam Mattress w/ Coordinated Bedspread
  - vii) USB 12V Chargers (3)
  - viii) Pleated Night Shades Throughout
  - ix) Solid Surface Galley Counter Top w/Covers

- Options:**
- Power & Cooling Upgrade Pkg\*
  - Hydraulic Jack
  - Hi Eff Power & Cooling Upgrade Pkg \*\*\*\*
  - Upgraded Hitch Roto Flex (Forced Option) — X**
  - Patio Railing System
  - Euro Chairs (Forced Option) — X**
  - Opposing Rear Power Dinette
  - Rear Power Patio Awning
  - Wireless Back up Camera
  - Triple 8,000 lb Axles
  - (1) 190W Solar w/2000W Pass Thru Inverter
  - 4 Door Refer Gas/Elec w/Panel Inserts
  - Residential Refer W/1 Add'l Solar Panel\*\*
  - Generator Auto Command (Forced Option W/Res Pkg)
  - Stainless Steel Galley Package
  - Supreme Package (Forced Option) — X**
  - Premier Package (Forced Option) — X**
  - Deluxe Package (Forced Option) — X**
  - Ceiling Fan (soffit delete)
  - Central Vacuum System
  - Keyless / Remote Entry Lock
  - Frameless Window Dual Pane
  - Queen Bed Memory Foam
  - EZ Flex Suspension for triple
  - Arctic Package\*\*\*
  - Upgraded Fan w/Remote (Lavy)
  - Upgraded Fan w/Remote (Rear)
  - Upgraded Fan w/Remote (Bedroom)
  - 2nd Grey Tank
  - USB 12V Charger Add'l
  - Double Insulated Roof
  - Cable Kit
  - Tool Box
  - Winterized
  - Fold Down Stairs w/Fold Entry DR Handle
  - Patriotic Pkg (Must Choose a Graphic Base Color)
  - Wi-Fi Ready (Forced Option) — X**
  - Glass Top Stove(Forced Option) — X**
  - Upgrade Package (Req'd) — X**
  - Pacific West Associates Tag (Req'd) — X**
  - RVIA Certification Tag (Req'd) — X**

- Standard Features - Included in Base Price**
- 4.0 KW ONAN Generator w/Transfer Switch
  - Slideout Duo Vanity/Wardrobe in Bedroom
  - A/C 15.0K BTU w/Ducting
  - 102" Wide Body Design
  - Flipped Axles w/No Wheelwells (Flat Floor Wall-to-Wall)
  - 16" Deluxe Aluminum Alloy Wheels
  - Two Swivel/Rocker Chairs w/Table, Slide-out Sofa Bed
  - Rear Table and Legs
  - Living Room 50" TV w/Swivel Bracket
  - 32" Bedroom TV w/ Swivel Bracket
  - Inset Coffered Ceiling Panel w/LED & Accent Lights
  - Counter-Top Edge LED Lighting - Switched
  - Power Awning w/LED Light Strip
  - 35,000 BTU Furnace
  - One-Piece PVC Vinyl Roof
  - Slam-Door Luggage Compartments
  - Stereo AM/FM/CD/DVD w/Bluetooth/USB/Subwoofer**
  - Dual 30 Lbs LP Tanks
  - Extra-Large Double Door Refrigerator (8 Cu. Ft.)
  - Rear Spoiler
  - Rear Screen Wall
  - Three-Burner Range w/Oven FURION 21"
  - Spray Away
  - TV Antenna w/Cable & Satellite Hook-Up
  - Two (2) Stab Jacks (Rear)
  - Upgraded roof vent in galley
  - 12v Powered Fan Roof Vent - Lavy
  - Roof Vent (Bunk Area)
  - Skylight Above Shower
  - Black Tank Flush
  - Carpet Kit
  - Bunk Ladder
  - Plumbed for Exterior LP Hookup
  - LED Rope Lights/Living Room Valances
  - LED Interior Lighting Throughout
  - Metal Lavy Sink w/stylish faucet
  - Water Filter
  - Large living room slide with sofa and refer/pantry cab

\* Includes 5.5KW Onan Generator Upgrade, 13.5K BTU Bedroom A/C (w/wall control), 50 Amp Service.  
 \*\* Includes Heated Enclosed Tanks/Valves, Reflected Floor Insulation, Heat Ducting System For Furnace, Double Insulation in Ceiling.  
 \*\*\*\* Includes 5.5KW Onan Generator Upgrade, W/3 each HI EFF 13.5K BTU AC's (Bedroom-galley(ducted)Rear), with 50 Amp Service