

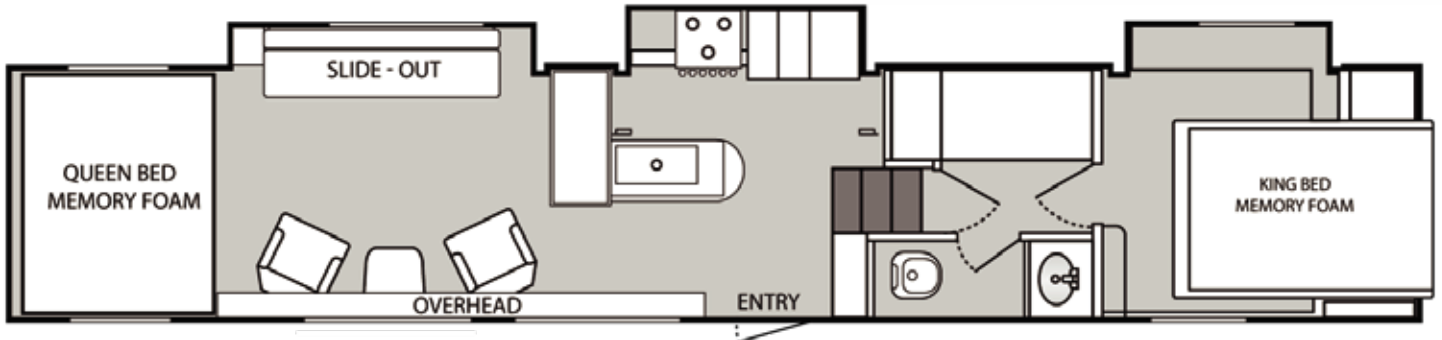

3815IKCA SPEC SHEET



UNIT SPECS

OVERALL LENGTH	36'0"
GVWR (lbs)	17,500
DRY WEIGHT (lbs)	13,430
HITCH WEIGHT (lbs)	2,710
AXLE WEIGHT (lbs)	10,720
AXLE CAPACITY (lbs)	7,000
CARGO CAPACITY (lbs)**	4,070
TIRE SIZE	16"
FRESH WATER (GAL)	160
GRAY WATER (GAL)	50
BLACK TANK (GAL)	50

Note: Weights may change due to options added.

Supreme Package - Includes:

- i) Dual landing gear motors with dual switch
- ii) 7000 lb Triple Axels with 16" wheels/G Rated Tires
- iii) 40-Gallon Fuel Station
- iv) External 110v Electrical Outlets
- v) Spare Tire & Carrier

Premier Package

- i) 8-Foot Laminated Ramp Door w/Beaver Tail
- ii) Hi-Gloss Fiberglass Sidewalls, Aluminum-Framed & Laminated
- iii) Large Designer Front Cap w/LED's
- iv) Exterior Folding Ladder w/ Walk-on Roof
- v) 10-Gallon Two-Way 110V / LP DSI Water Heater
- vi) Sewer Hose Compartment
- vii) LED Exterior Flood Lights
- viii) LED Exterior Running Lights & Tail Lights

Deluxe Package

- i) Power Sofa Bed (Rear) & Upper Bunk (Powered)
- ii) Shower & Glass Enclosure
- iii) Stainless Deep Galley Sink w/Pull-Down Faucet
- iv) Microwave (Extra Large Over-the-Range Residential)
- v) Exterior TV Bracket & Hookups
- vi) RV King Memory Foam Mattress w/ Coordinated Bedspread
- vii) USB 12V Chargers (3)
- viii) Pleated Night Shades Throughout
- ix) Solid Surface Galley Counter Top w/Covers
- x) 110v Fireplace w/cabinet in bedroom

Options:

- Power & Cooling Upgrade Pkg*
- Hi Eff Power & Cooling Upgrade Pkg******
- Hydraulic Jack
- Queen Bed Memory Foam
- Upgraded Hitch Roto Flex (Forced Option) — X**
- Patio Railing System
- Rear Power Patio Awning
- Opposing Dinn
- Euro Chairs (Forced Option) — X**
- Wireless Back up Camera
- Triple 8,000 lb Axles
- 190W Solar w/2000W Pass Thru Inverter
- Generator Auto Command (Forced Option w/Res Pkg)
- 4 Door Refer gas/elec w/panel inserts
- Residential Refer with 1 add'l Solar Panel
- Stainless Steel Galley Package
- Supreme Package (Forced Option) — X**
- Premier Package (Forced Option) — X**
- Deluxe Package (Forced Option) — X**
- Central Vacuum System
- Keyless / Remote Entry Lock
- Frameless Dual-Pane Windows
- Upgraded Fan w/Remote BEDROOM
- Upgraded Fan w/Remote REAR
- Upgraded Fan w/Remote LAVY
- USB 12V Charger Add'l
- EZ Flex Suspension Triple
- Arctic Package***
- Double Insulated Roof
- Cable Kit
- Winterized
- Tool Box
- Fold Down Stairs w/Fold Entry DR Handle
- Patriotic Pkg (Must Choose a Graphic Base Color)
- Wi Fi Ready (Forced Option) — X**
- Glass Top Stove (Forced Option) — X**
- Upgrade Package (Req'd) — X**
- Pacific West Associates Tag (Req'd) — X**
- RVIA Certification Tag (Req'd) — X**

Standard Features - Included in Base Price

- 4.0 KW ONAN Generator w/Transfer Switch
- A/C 15.0K BTU w/Ducting
- Slideout Duo Vanity/Wardrobe in Bedroom
- 102" Wide Body Design
- Flipped Axles w/No Wheelwells (Flat Floor Wall-to-Wall)
- 16" Deluxe Aluminum Alloy Wheels
- Inset Coffered Ceiling Panel w/LED & Accent Lights
- Counter-Top Edge LED Lighting - Switched
- Power Awning w/LED Light Strip
- 35,000 BTU Furnace
- One-Piece PVC Vinyl Roof
- Slam-Door Luggage Compartments
- Stereo AM/FM/CD/DVD w/Bluetooth/USB
- Dual 30 Lbs LP Tanks
- Rear Spoiler
- Rear Screen Wall
- Three-Burner Range w/Oven/glass cover
- Spray Away
- TV Antenna w/Cable & Satellite Hook-Up
- Two (2) Stab Jacks (Rear)
- 12v Roof Vent (Bunk Area)
- Black Tank Flush
- Carpet Kit
- Bunk Ladder
- Plumbed for Exterior LP Hookup
- LED Rope Lights/Living Room Valances
- LED Interior Lighting Throughout
- Metal Lavy Sink w/Stylish faucet
- Upgrade power vent Galley w/remote
- Slide-out w/Sofa Bed with side table cabinets
- Slide out Refer/stove
- 2 Rear Table and Legs at Dinn
- Upgraded Towel bar, ring, TP holder, Robe hook
- Living Room 50" TV w/Swivel Bracket
- 32" TV in bedroom
- 110v Fireplace in cargo back of galley cab
- Large Island galley w/pendant lighting
- Torque friction entry door hinges
- Large double door refer(8cube)
- Skylight Above Shower
- Torque friction entry door hinges
- 2ND Grey tank

* Includes 5.5KW Onan Generator Upgrade, 13.5K BTU Bedroom A/C (**w/wall control**), 50 Amp Service.

*** Includes Heated Enclosed Tanks/Valves, Reflected Floor Insulation, Heat Ducting System For Furnace, Double Insulation in Ceiling.

Note: Due to possible changes from suppliers, Genesis Supreme reserves the right to substitute materials at anytime. Standard/Optional features may change without notice. REV 1.18.23