

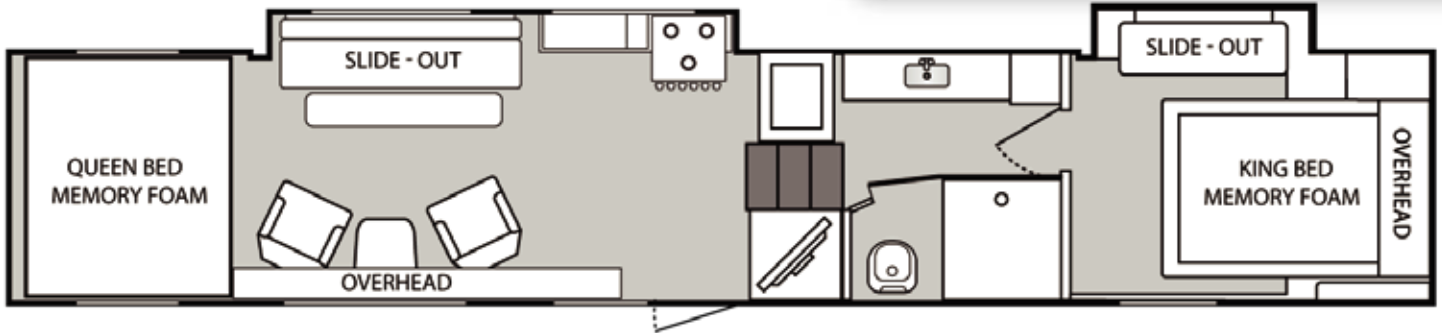

365CA SPEC SHEET



Supreme Package - Includes:

- i) Dual landing gear motors with dual switch
- ii) 8000 lb Dual Axels with 16" wheels/G Rat -ed Tires
- iii) 40-Gallon Fuel Station
- iv) External 110v Electrical Outlets
- v) Spare Tire & Carrier

Premier Package

- i) 8-Foot Laminated Ramp Door w/Beaver Tail
- ii) Hi-Gloss Fiberglass Sidewalls, Aluminum-Framed & Laminated
- iii) Large Designer Front Cap w/LED's
- iv) Exterior Folding Ladder w/ Walk-on Roof
- v) 10-Gallon Two-Way 110V / LP DSI Water Heater
- vi) Sewer Hose Compartment
- vii) LED Exterior Flood Lights
- viii) LED Exterior Running Lights & Tail Lights

Deluxe Package

- i) Power Sofa Bed (Rear) & Upper Bunk (Power)
- ii) Shower & Glass Enclosure
- iii) Stainless Deep Galley Sink w/Pull-Down Faucet
- iv) Microwave(Extra Large Over-the-Range Residential)
- v) Exterior TV Bracket & Hookups
- vi) RV King Memory Foam Mattress w/ Coordinated Bedspread
- vii) USB 12V Chargers (3)
- viii) Pleated Night Shades Throughout
- ix) Solid Surface Galley Counter Top w/Covers
- x) 110v Fireplace w/cabinet in bedroom

UNIT SPECS

OVERALL LENGTH	36'0"
GVWR (lbs)	16,000
DRY WEIGHT (lbs)	11,730
HITCH WEIGHT (lbs)	2,960
AXLE WEIGHT (lbs)	8,770
AXLE CAPACITY (lbs)	8,000
CARGO CAPACITY (lbs)**	4,270
TIRE SIZE	16"
FRESH WATER (GAL)	160
GRAY WATER (GAL)	50
BLACK TANK (GAL)	50

Note: Weights may change due to options added.

Options:

- Power & Cooling Upgrade Pkg*
- Hydraulic Jack
- Queen Bed Memory Foam
- Upgraded Hitch Roto Flex(Forced Option) -X**
- Patio Railing System
- Rear Power Patio Awning
- Opposing Dinn
- Euro Chairs (Forced Option) -X**
- Wireless Back up Camera
- 190W Solar w/2000W Pass Thru Inverter
- Generator Auto Command (Forced Option W/Res Pkg)
- 4 Door Refer Gas/Elec w/Panel Inserts
- Residential Refer with 1 add'l Solar Panel
- Stainless Steel Galley Package
- Supreme Package (Forced Option) -X**
- Premier Package (Forced Option) -X**
- Deluxe Package (Forced Option) -X**
- Central Vacuum System
- Keyless / Remote Entry Lock
- Coffee Maker Stand in Galley
- Frameless Dual-Pane Windows
- Upgraded Fan w/Remote in Lavy
- Upgraded Fan w/Remote in Bedroom
- Upgraded Fan w/Remote in Rear
- USB 12V Charger Add'l
- EZ Flex Suspension
- Arctic Package***
- 2nd Grey Tank
- Double Insulated Roof
- Cable Kit
- Winterized
- Tool Box
- Patriotic Pkg (Must Choose a Graphic Base Color)
- Wi-Fi Ready (Req'd) -X**
- Upgrade Package (Req'd) -X**
- Glass Top Stove(Forced Option) -X**
- Pacific West Associates Tag (Req'd) -X**
- RVIA Certification Tag (Req'd) -X**

Standard Features - Included in Base Price

- 4.0 KW ONAN Generator w/Transfer Switch
- A/C 15.0K BTU w/Ducting
- Slideout Duo Vanity/Wardrobe in Bedroom
- 102" Wide Body Design
- Flipped Axles w/No Wheelwells(Flat Floor Wall-to-Wall)
- 16" Deluxe Aluminum Alloy Wheels
- Two Swivel/Rocker Chairs w/Table
- Inset Coffered Ceiling Panel w/LED & Accent Lights
- Counter-Top Edge LED Lighting - Switched
- Power Awning w/LED Light Strip
- 35,000 BTU Furnace
- One-Piece PVC Vinyl Roof
- Slam-Door Luggage Compartments
- Stereo AM/FM/CD/DVD w/Bluetooth/USB
- Dual 30 Lbs LP Tanks
- Rear Screen Wall
- Three-Burner Range w/Oven in main slide
- Flip up sofa in main slide out
- Black Tank Flush
- Carpet Kit
- Bunk Ladder
- Plumbed for Exterior LP Hookup
- LED Rope Lights/Living Room Valances
- LED Interior Lighting Throughout
- Skylight Above Shower
- Single metal Lavy sink w/mirror & oh cabinets
- Spray Away
- Living Room 40" TV w/Swivel Bracket
- Extra-Large refer (8CU)
- Torque friction entry door hinges
- Roof Vent (Bunk Area)
- TV Antenna w/Cable & Satellite Hook-Up
- Two (2) Stab Jacks (Rear)
- Rear Spoiler
- 12v Powered Fan Roof Vent - Lavy

* Includes 5.5KW Onan Generator Upgrade, 13.5K BTU Bedroom A/C(w/wall control) , 50 Amp Service

*** Includes Heated Enclosed Tanks/Valves,Reflected Floor Insulation,Heat Ducting System For Furnace,Double Insulation in Ceiling

Note: Due to possible changes from suppliers, Genesis Supreme reserves the right to substitute materials at anytime. Standard/Optional features may change without notice. REV 1.18.23