

VORTEX

3414V SPEC SHEET

3414V

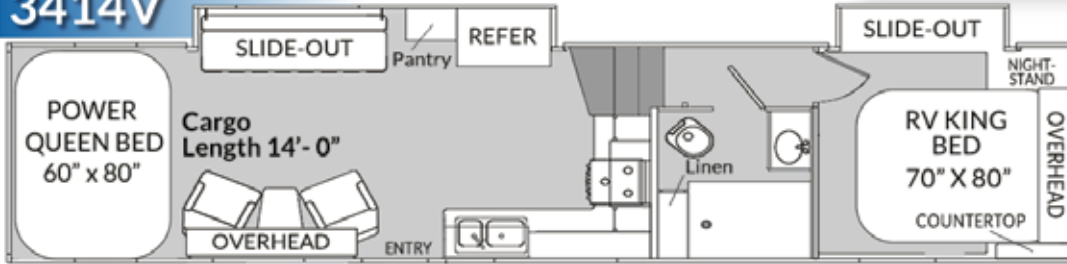

OVERALL LENGTH	GVWR	DRY WEIGHT	HITCH WEIGHT	AXLE WEIGHT	CAPACITY		TIRE SIZE	WATER		
					AXLE	CARGO		FRESH	GRAY	BLACK
36'- 10"	15,050	11,260	2,640	8,620	7,000	3,790	16"	160	50	50
LBS					GAL					

UNIT SPECS	
OVERALL LENGTH	36'10"
GVWR (lbs)	15,050
DRY WEIGHT (lbs)	11,260
HITCH WEIGHT (lbs)	2,640
AXLE WEIGHT (lbs)	8,620
AXLE CAPACITY (lbs)	7,000
CARGO CAPACITY (lbs)**	3,790
TIRE SIZE	16"
FRESH WATER (GAL)	160
GRAY WATER (GAL)	50
BLACK TANK (GAL)	50
Note: Weights may change due to options added.	

Supreme Package - Includes:

- i) Dual landing gear motors with dual switch
- ii) 7000 lb Dual Axels with 16" wheels/G Rated Tires
- iii) 40-Gallon Fuel Station
- iv) External 110v Electrical Outlets
- v) Spare Tire & Carrier

Premier Package

- i) 8-Foot Laminated Ramp Door w/Beaver Tail
- ii) Hi-Gloss Fiberglass Sidewalls, Aluminum-Framed & Laminated
- iii) Large Designer Front Cap w/LED's
- iv) Exterior Folding Ladder w/ Walk-on Roof
- v) 10-Gallon Two-Way 110V / LP DSI Water Heater
- vi) Sewer Hose Compartment
- vii) LED Exterior Flood Lights
- viii) LED Exterior Running Lights & Tail Lights

Deluxe Package

- i) Power Sofa Bed (Rear) & Upper Bunk (Power)
- ii) Shower & Glass Enclosure
- iii) Stainless Deep Galley Sink w/Pull-Down Faucet
- iv) Microwave(Extra Large Over-the-Range Residential)
- v) Exterior TV Bracket & Hookups
- vi) RV King Memory Foam Mattress w/Coordinated Bedspread
- vii) USB 12V Chargers (3)
- viii) Pleated Night Shades Throughout
- ix) Solid Surface Galley Counter Top w/Covers

Options:

- Power & Cooling Upgrade Pkg*
- Hi Eff Power & Cooling Upgrade Pkg****
- Hydraulic Jack
- Upgraded Hitch Roto Flex (Forced Option) — X**
- Patio Railing System
- Euro Chairs (Forced Option) — X**
- Opposing Rear Power Dinette
- Rear Power Patio Awning
- Dual 8,000lb Axles
- Wireless Back up Camera
- 190W Solar w/2000W Pass Thru Inverter
- 4 Door Refer Gas/Elec w/Panel Inserts
- Residential Refer W/1 Add'l Solar Panel
- Generator Auto Command (Forced Option W/Residential)
- Stainless Steel Galley Package
- Supreme Package (Forced Option) — X**
- Premier Package (Forced Option) — X**
- Deluxe Package (Forced Option) — X**
- Central Vacuum System
- Keyless / Remote Entry Lock
- Coffee Maker Stand in Galley
- Frameless Dual-Pane Windows
- Double Insulated Roof
- 2nd Grey Tank
- Upgraded Fan w/Remote (Rear or Bedroom)
- Upgraded Fan w/Remote (Lavy)
- Arctic Package***
- Cable Kit
- Winterized
- Tool Box
- Patriotic Pkg (Must Choose a Graphic Base Color)
- Wi-Fi Ready (Forced Option) — X**
- Upgraded Graphics Pkg (Forced Option) — X**
- Grey Skirting (Forced Option) — X**
- Glass Top Stove(Forced Option) — X**
- Upgrade Package (Req'd) — X**
- Pacific West Associates Tag (Req'd) — X**
- RVIA Certification Tag (Req'd) — X**

Standard Features - Included in Base Price

- Slideout Duo Vanity/Wardrobe in Bedroom
- EZ Flex Suspension
- Pull Down Stairs w/Fold Entry DR Handle
- Living Room Sofa/Microwave Slideout
- Upgraded power vent in Galley
- 4.0 KW ONAN Generator w/Transfer Switch
- A/C 15.0K BTU w/Ducting
- 102" Wide Body Design
- Flipped Axles w/No Wheelwells (Flat Floor Wall-to-Wall)
- 16" Deluxe Aluminum Alloy Wheels
- Two Swivel/Rocker Chairs w/Table, Slide-out Sofa Bed
- Rear Table and Legs
- Living Room 40" TV w/Swivel Bracket
- 32" Bedroom TV w/Built-In DVD Player & Swivel Bracket
- Inset Coffered Ceiling Panel w/LED & Accent Lights
- Counter-Top Edge LED Lighting - Switched
- Power Awning w/LED Light Strip
- 30,000 BTU Furnace
- One-Piece PVC Vinyl Roof
- Dual 30 Lbs LP Tanks
- Extra-Large Double Door Refrigerator (8 Cu. Ft.)
- Rear Spoiler
- Ceiling Fan
- Rear Screen Wall
- Metal Lavy Sink
- Spray Away
- TV Antenna w/Cable & Satellite Hook-Up
- Two (2) Stab Jacks (Rear)
- 12v Powered Fan Roof Vent - Lavy
- Roof Vent (Bunk Area)
- Skylight Above Shower
- Black Tank Flush
- Carpet Kit
- Bunk Ladder
- Plumbed for Exterior LP Hookup
- LED Rope Lights/Living Room Valances
- LED Interior Lighting Throughout
- Stereo AM/FM/CD/DVD w/Bluetooth/USB & Subwoofer

* Includes 5.5KW Onan Generator Upgrade, 13.5K BTU Bedroom A/C, 50 Amp Service

** Includes 5.5KW Onan Generator Upgrade, W/3 each HI EFF 13.5K BTU AC's (Bedroom-galley(ducted)Rear), with 50 Amp Service.

*** Includes Heated Enclosed Tanks/Valves, Reflected Floor Insulation, Heat Ducting System For Furnace, Double Insulation in Ceiling.