

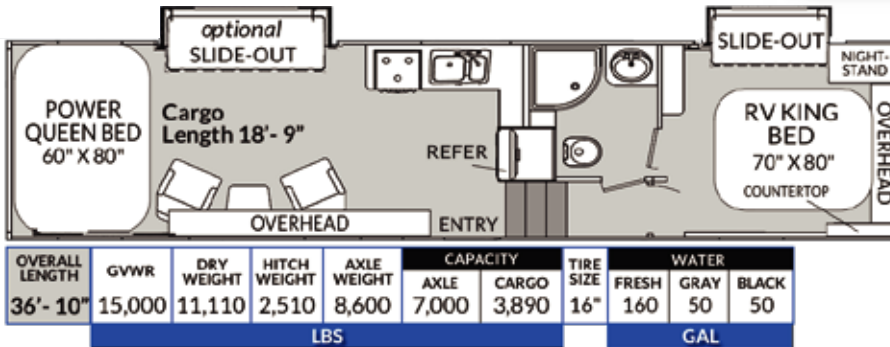

3219RCRXL SPEC SHEET



| UNIT SPECS | |
|------------------------|--------|
| OVERALL LENGTH | 36'10" |
| GVWR (lbs) | 15,000 |
| DRY WEIGHT (lbs) | 11,110 |
| HITCH WEIGHT (lbs) | 2,510 |
| AXLE WEIGHT (lbs) | 8,600 |
| AXLE CAPACITY (lbs) | 7,000 |
| CARGO CAPACITY (lbs)** | 3,890 |
| TIRE SIZE | 16" |
| FRESH WATER (GAL) | 160 |
| GRAY WATER (GAL) | 50 |
| BLACK TANK (GAL) | 50 |

Note: Weights may change due to options added.

Supreme Package - Includes:

- i) Dual landing gear motors with dual switch
- ii) 7000 lb Dual Axels with 16" wheels/G Rated Tires
- iii) 40-Gallon Fuel Station
- iv) External 110v Electrical Outlets
- v) Spare Tire & Carrier

Premier Package

- i) 8-Foot Laminated Ramp Door w/Beaver Tail
- ii) Hi-Gloss Fiberglass Sidewalls, Aluminum-Framed & Laminated
- iii) Large Designer Front Cap w/LED's
- iv) Exterior Folding Ladder w/ Walk-on Roof
- v) 10-Gallon Two-Way 110V / LP DSI Water Heater
- vi) Sewer Hose Compartment
- vii) LED Exterior Flood Lights
- viii) LED Exterior Running Lights & Tail Lights

Deluxe Package

- i) Power Sofa Bed (Rear) & Upper Bunk (Power)
- ii) Shower & Glass Enclosure
- iii) Stainless Deep Galley Sink w/Pull-Down Faucet
- iv) Microwave (Extra Large Over-the-Range Residential)
- v) Exterior TV Bracket & Hookups
- vi) RV King Memory Foam Mattress w/ Coordinated Bedspread
- vii) USB 12V Chargers (3)
- viii) Pleated Night Shades Throughout
- ix) Solid Surface Galley Counter Top w/Covers

Options:

- Power & Cooling Upgrade Pkg*
- Hydraulic Jack
- Upgraded Hitch Roto Flex (Forced Option) — X**
- Living Room Sofa Slideout
- Queen Bed Memory Foam
- Patio Railing System
- Euro Chairs (Forced Option) — X**
- Opposing Rear Power Dinette
- 40" TV IPO 32" TV (only avail. w/4 DR Refer Option)
- Rear Power Patio Awning
- Wireless Back up Camera
- Dual 8,000 lb Axles
- 190W Solar w/2000W Pass Thru Inverter
- 4 Door Refer Gas/Elec w/ Panel Inserts
- Residential Refer W/1 Add'l Solar Panel
- Generator Auto Command (Forced Option W/Res Pkg)
- Stainless Steel Galley Package
- Supreme Package (Forced Option) — X**
- Premier Package (Forced Option) — X**
- Deluxe Package (Forced Option) — X**
- Central Vacuum System
- Keyless / Remote Entry Lock
- Coffee Maker Stand in Galley
- Frameless Dual-Pane Windows
- EZ Flex Suspension
- Upgraded Fan w/Remote (Lavy)
- Upgraded Fan w/Remote (Rear or Bedroom)
- 2nd Grey Tank
- USB 12V Charger Add'l
- Arctic Package***
- Double Insulated Roof
- Cable Kit
- Winterized
- Tool Box
- Fold Down Stairs w/Fold Entry DR Handle
- Patriotic Pkg (Must Choose a Graphic Base Color)
- Wi-Fi Ready (Forced Option) — X**
- Glass Top Stove(Forced Option) — X**
- Upgrade Package (Req'd) — X**
- Pacific West Associates Tag (Req'd) — X**
- RVIA Certification Tag (Req'd) — X**

Standard Features - Included in Base Price

- 4.0 KW ONAN Generator w/Transfer Switch
- A/C 15.0K BTU w/Ducting
- Slideout Duo Vanity/Wardrobe in Bedroom
- 102" Wide Body Design
- Flipped Axles w/No Wheelwells (Flat Floor Wall-to-Wall)
- 16" Deluxe Aluminum Alloy Wheels
- Two Swivel/Rocker Chairs w/Table, Slide-out Sofa Bed
- Rear Table and Legs
- Living Room 32" TV w/Swivel Bracket
- 32" Bedroom TV w/ Swivel Bracket
- Inset Coffered Ceiling Panel w/LED & Accent Lights
- Solid Surface Galley Counter Top w/Covers
- Counter-Top Edge LED Lighting - Switched
- Power Awning w/LED Light Strip
- 30,000 BTU Furnace
- One-Piece PVC Vinyl Roof
- Slam-Door Luggage Compartments
- Stereo AM/FM/CD/DVD w/Bluetooth/USB
- Rear Spoiler
- Ceiling Fan
- Rear Screen Wall
- Three-Burner Range w/Oven
- Spray Away
- TV Antenna w/Cable & Satellite Hook-Up
- Two (2) Stab Jacks (Rear)
- 12v Powered Fan Roof Vent - Lavy
- Roof Vent (Bunk Area)
- Skylight Above Shower
- Black Tank Flush
- Carpet Kit
- Bunk Ladder
- Plumbed for Exterior LP Hookup
- LED Rope Lights/Living Room Valances
- LED Interior Lighting Throughout
- Metal Lavy Sink w/Stylish faucet
- Dual 30 Lbs LP Tanks
- Extra-Large Double Door Refrigerator (8 Cu. Ft.)
- Dresser in Bedroom

* Includes 5.5KW Onan Generator Upgrade, 13.5K BTU Bedroom A/C (w/wall control) , 50 Amp Service.

*** Includes Heated Enclosed Tanks/Valves, Reflected Floor Insulation, Heat Ducting System For Furnace, Double Insulation in Ceiling.